

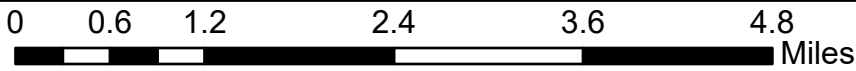

Volunteer Wildlife Monitoring Program (VWMP) Frog and Toad Survey

Inactive Route Map Route ID: 360418 County: Monroe

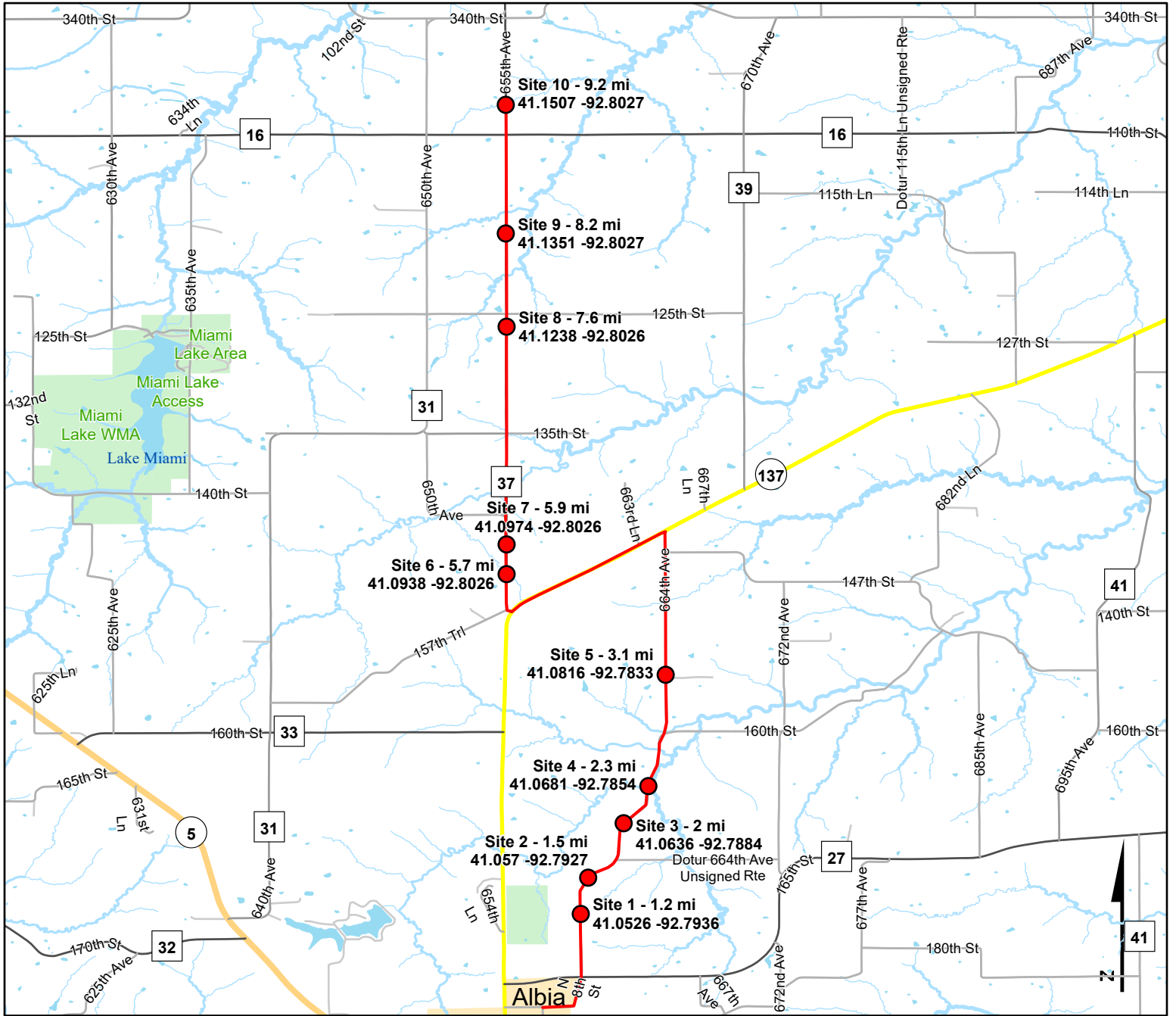

- Frog and Toad Survey Sites
- Frog and Toad Survey Route

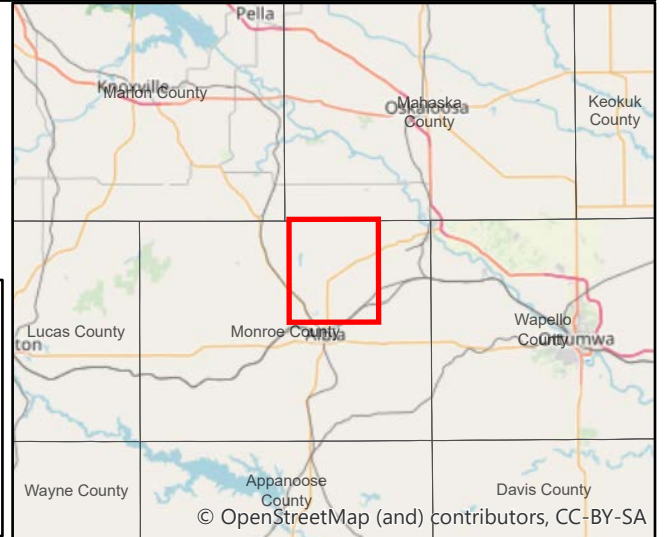

DNR
Volunteer Wildlife Monitoring Program



Questions? Contact the VWMP Coordinator at vwmp@dnr.iowa.gov.

Created on: 4/4/2019



Volunteer Wildlife Monitoring Program (VWMP) Frog and Toad Survey

Inactive Route Table Route ID: 360418 County: Monroe



SiteNum	Site_Name	Directions
1	1.2	Start at corner of 664th ave and hwy 137 at ball diamond 1.2 miles on 664th ave from start. Sign for 664th ave is not there. Sports complex sign is. Small farm pond on left (west) side of road.
2	1.5	Continue around curves for .3 miles. Small farm pond on right side of road.
3	2	Continue on 664 for .5 miles. Farm pond to left of road.
4	2.3	Continue on 664 for about .4 miles to little creek that runs under road. Creek runs parallel to road for about .3 miles.
5	3.1	Go north .8 miles. Farm pond about 100 meters to left (west) side of road. Woodland pool to right side.
6	5.7	North on 664 for 1.2 miles left onto hwy 137 for 1.1 miles. Right on 665th ave. North past cemetery for .3 miles. Small stream runs under road.
7	5.9	North .2 miles to farm pond on left (west) side of road.
8	7.6	Continue north for 1.8 miles. Small wetland like complex to left of road with pond.
9	8.2	North .6 miles on 655th ave. Tiny little flooded ditch like pool to right of road.
10	9.2	North past 110th street intersection. 1.0 miles from last stop. Little creek/stream