

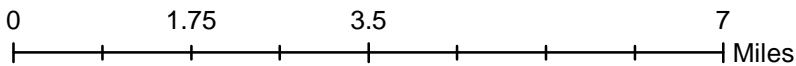

# Volunteer Wildlife Monitoring Program (VWMP) Frog and Toad Survey

Route ID: 360304 Start County: Hancock

Click for Google Maps to Site 1: <https://www.google.com/maps/dir/?api=1&destination=43.1114006,-93.9506989>

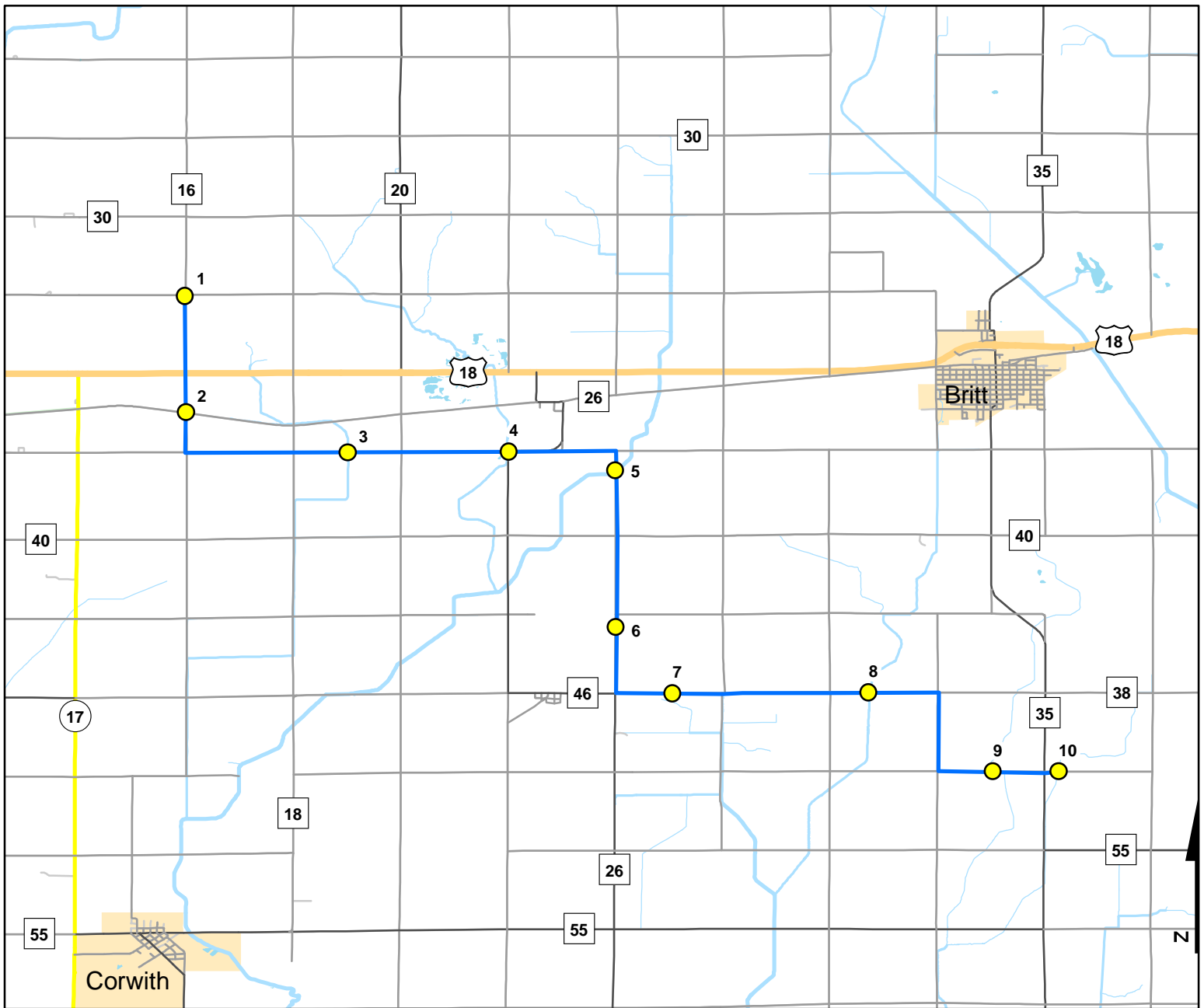

## Legend

● Stop Locations

— Route Path

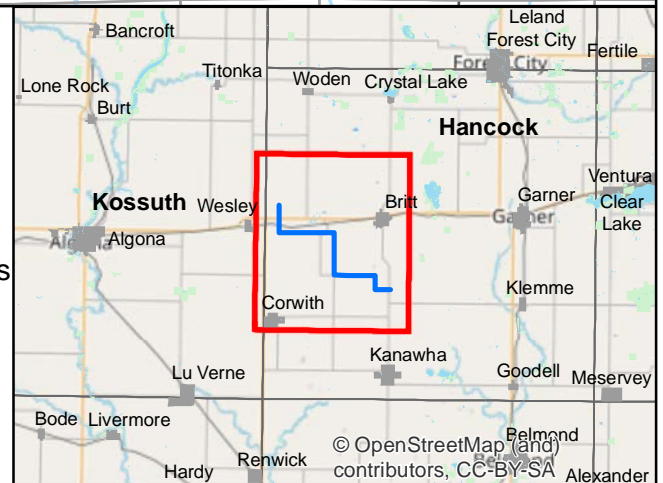



# Volunteer Wildlife Monitoring Program (VWMP) Frog and Toad Survey

Route ID: 360304 Start County: Hancock

Click for Google Maps to Site 1: <https://www.google.com/maps/dir/?api=1&destination=43.1114006,-93.9506989>

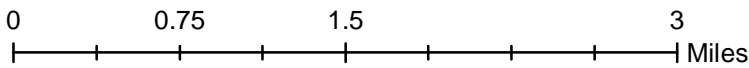
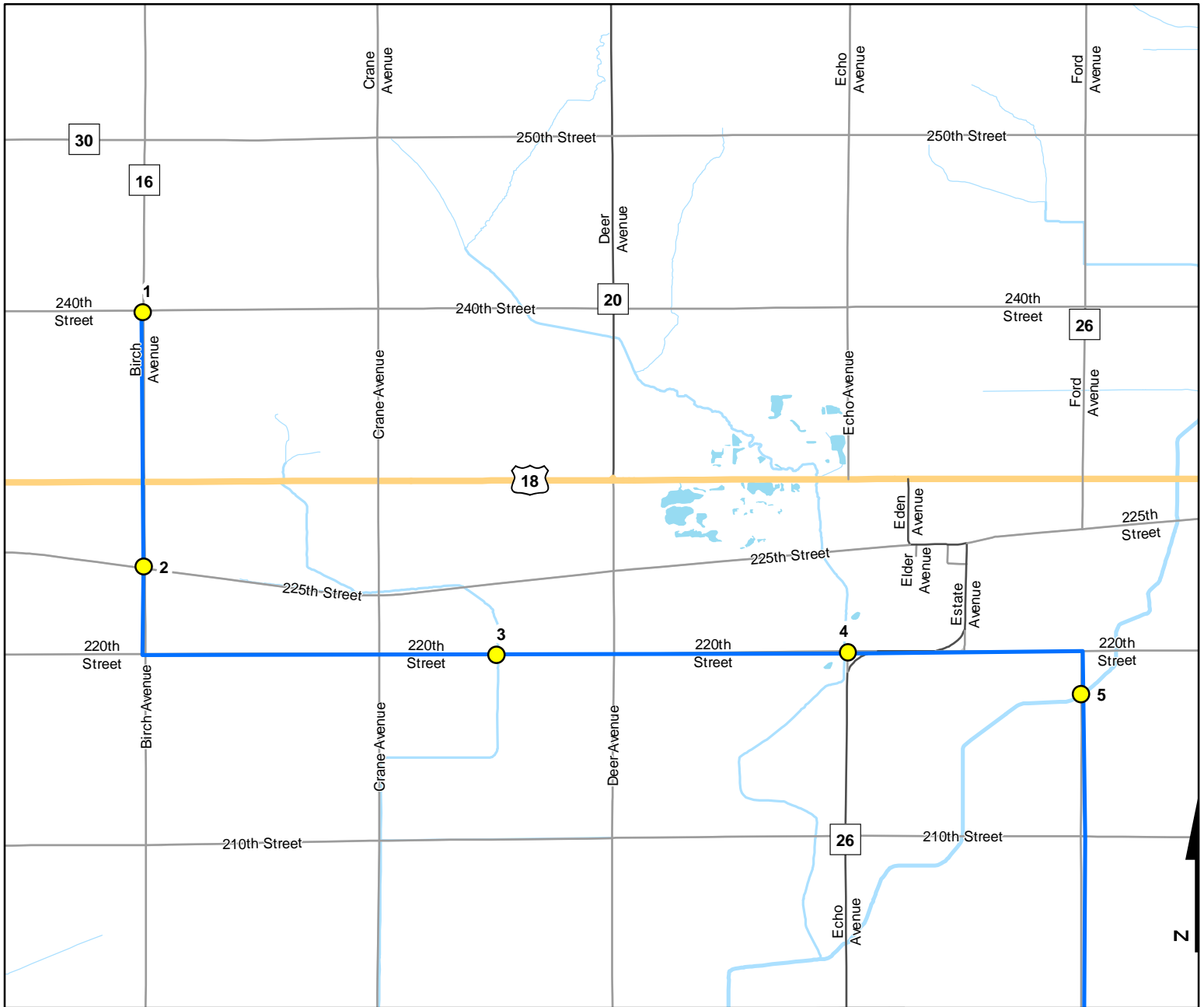

### Legend

● Stop Locations

— Route Path

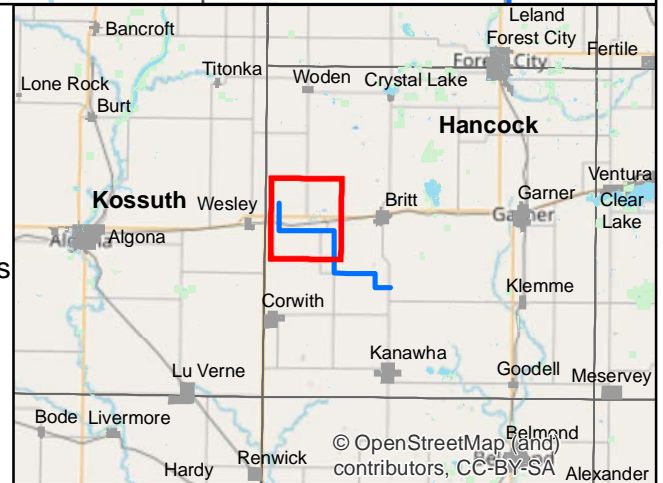



# Volunteer Wildlife Monitoring Program (VWMP) Frog and Toad Survey

Route ID: 360304 Start County: Hancock

Click for Google Maps to Site 1: <https://www.google.com/maps/dir/?api=1&destination=43.1114006,-93.9506989>

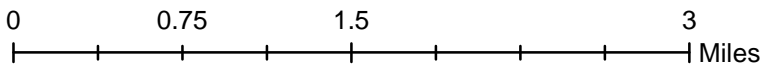
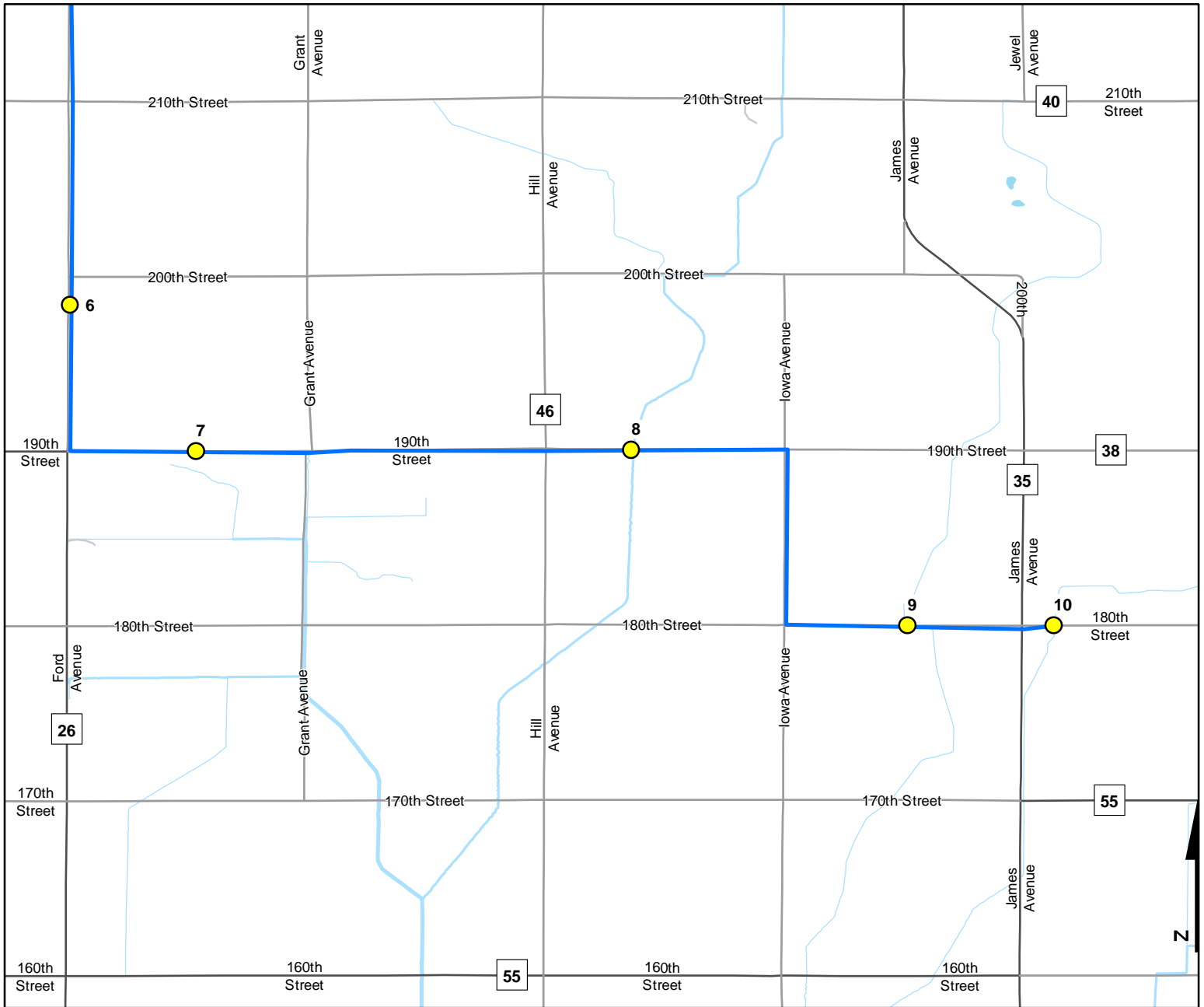

## Legend

● Stop Locations

— Route Path

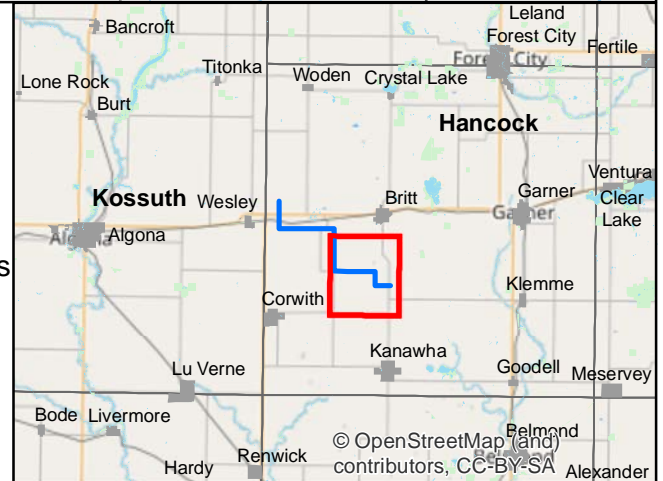



# Frog and Toad Call Survey Route Description

Route ID **360304**

Established:

Site Number	Name	County	Latitude	Longitude	Directions
1	0	Hancock	43.1114006	-93.9506989	Corner of 240th and Birch facing south. Ditch on east side of road holding water.
2	1.4	Hancock	43.0900002	-93.9505997	Go south on Birch. Corner of Birch and 225th. Wide ditch next to railroad traks with slough grass.
3	3.4	Hancock	43.0825996	-93.9208984	South on Birch, East (left) on 220th, cross Crane. High channelized and eroded ditch/stream. Bridge about 0.3 miles East of Crane.
4	4.8	Hancock	43.0828018	-93.8912964	Continue east on 220th. Narrow bridge over channelized creek at corner of 220th and Echo (west side of Echo)
5	6.1	Hancock	43.0792999	-93.8716965	Continue east on 220th. Turn south on Ford. Another ditched creek. Bridge 0.1 miles south on Ford ave.
6	7.1	Hancock	43.050499	-93.8715973	Contine south on Ford. Wet ditch with Equisetum (horsetail). East side of road about .2 miles south of intersection with 210th.
7	9.4	Hancock	43.0383987	-93.8611984	Reed canary grass filled ditch next to a little wood lot. South side of 190th
8	11.2	Hancock	43.0385017	-93.8252029	Continue east on 190th. Bridge over grass. Lined, mostly channelized stream. About .2 miles east of Hill ave on 190th.
9	13.3	Hancock	43.0239983	-93.8023987	Continue east on 190th, turn south Iowa, turn East on 180th. Channelized creek, somewhat pooled on south side of 180th about 0.3 miles east of Iowa ave.



# Frog and Toad Call Survey Route Description

10

14

Hancock

43.0239983

-93.7902985

Continue east on 180th. Another channelized creek just east of intersection with James ave on 180th.