

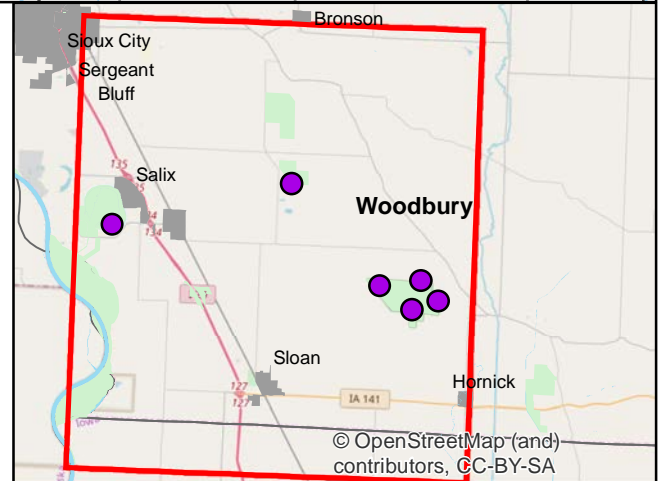

Volunteer Wildlife Monitoring Program (VWMP) Frog and Toad Survey

Route ID: 235 County: Woodbury

Click for Google Maps to Site 1: <https://www.google.com/maps/dir/?api=1&destination=42.3299315627,-96.2135318422>

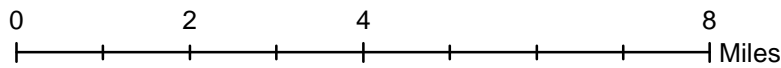
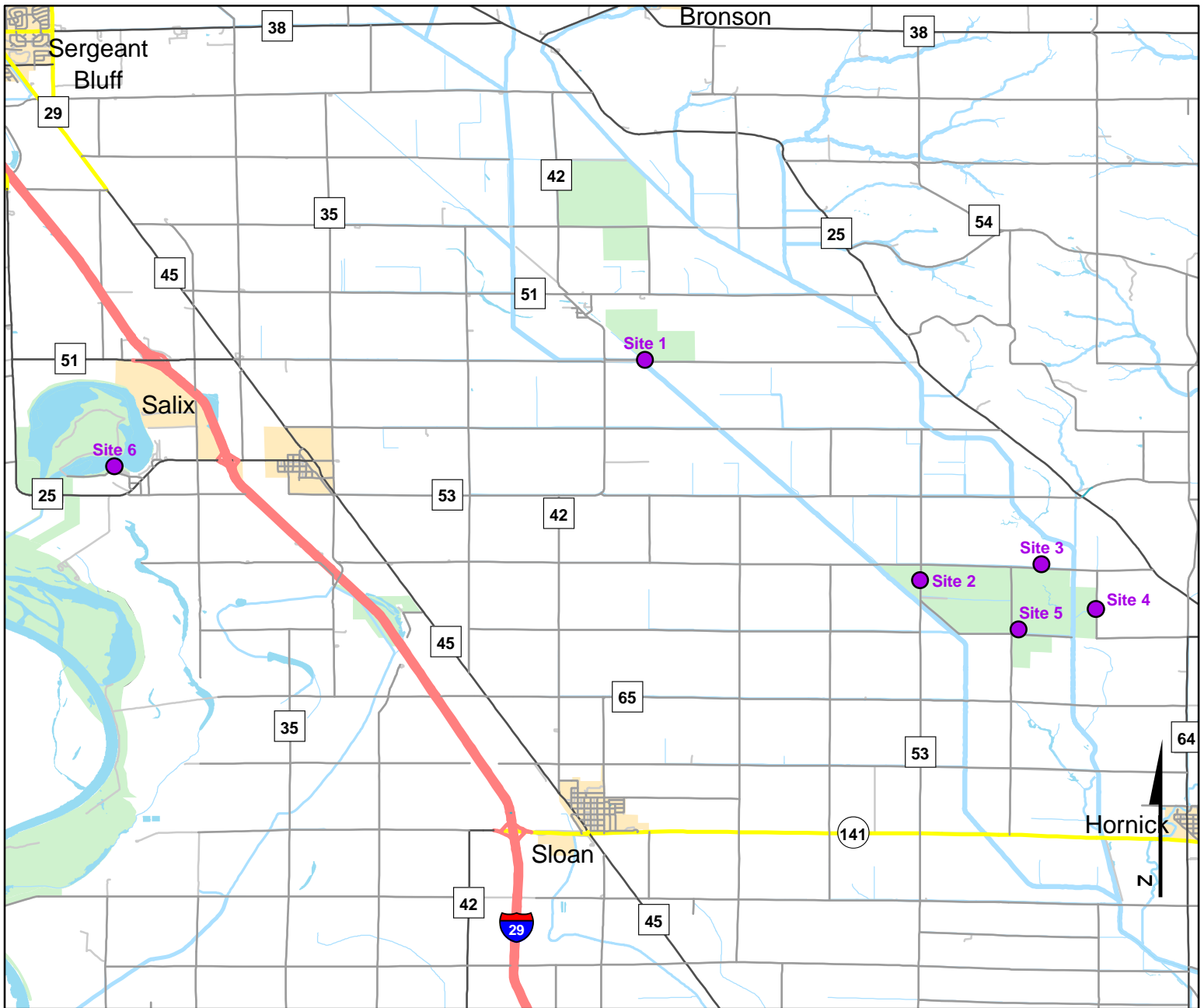



Volunteer Wildlife Monitoring Program (VWMP) Frog and Toad Survey

Route ID: 235 County: Woodbury

Click for Google Maps to Site 1: <https://www.google.com/maps/dir/?api=1&destination=42.3299315627,-96.2135318422>

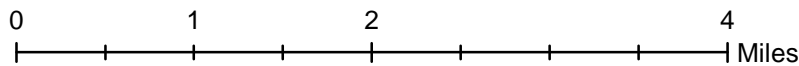
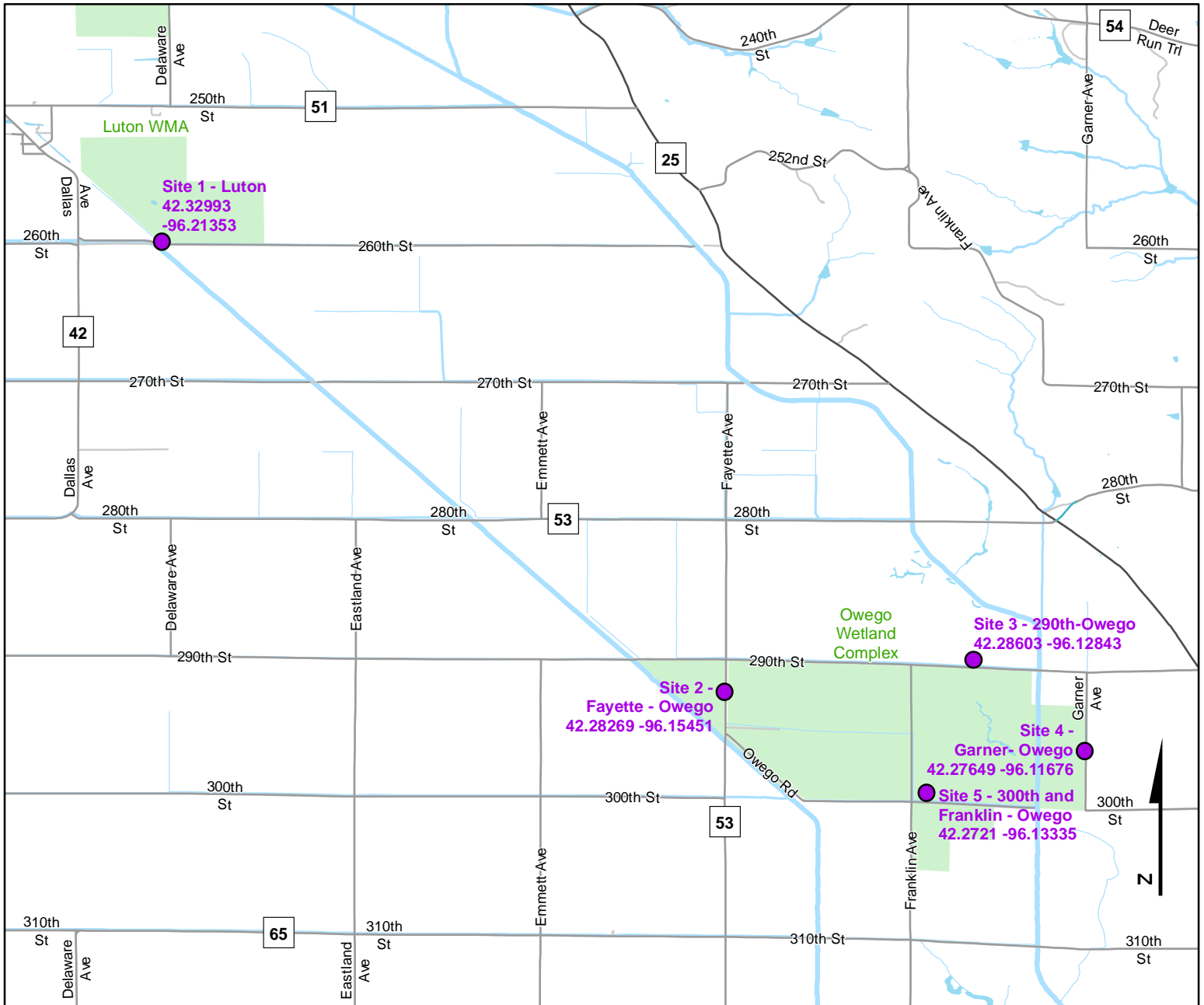

Legend

----- Trails

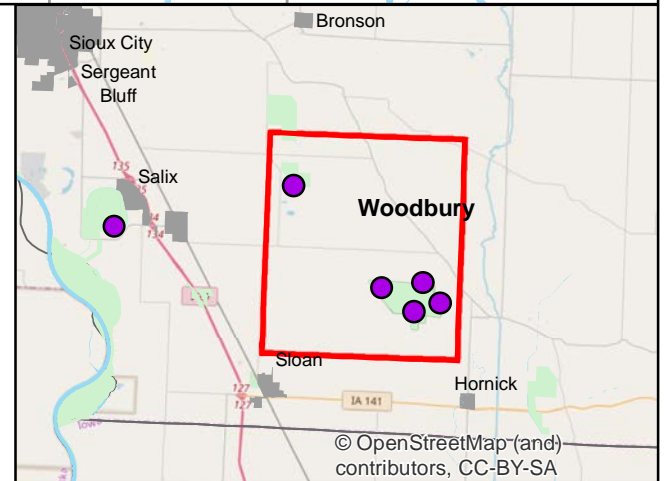



Volunteer Wildlife Monitoring Program (VWMP) Frog and Toad Survey

Route ID: 235 County: Woodbury

Click for Google Maps to Site 1: <https://www.google.com/maps/dir/?api=1&destination=42.3299315627,-96.2135318422>

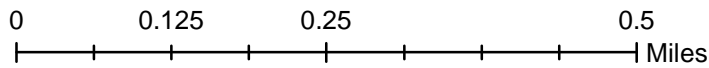

DNR
**Volunteer
 Wildlife
 Monitoring
 Program**

Legend

----- Trails

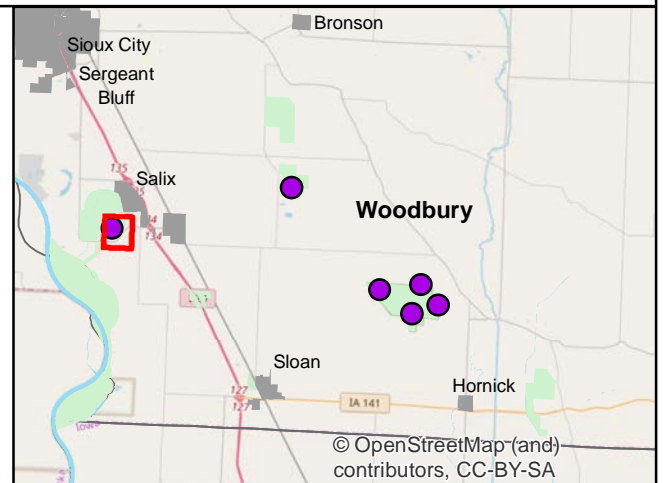



Frog and Toad Call Survey Route Description

Route ID **235**

Established: 2005

Site Number	Name	County	Latitude	Longitude	Directions
1	Luton	Woodbury	42.3299316	-96.2135318	At parking area for Luton WMA, just off of 260th St south of the town of Luton
2	Fayette - Owego	Woodbury	42.2826859	-96.1545132	At Owega Wetland Complex, on Fayette Avenue just south of the intersection with 290th St
3	290th-Owego	Woodbury	42.2860285	-96.1284346	1.3 mi. West of Fayette Ave. and 290th St. North side of road.
4	Garner- Owego	Woodbury	42.2764933	-96.1167581	On Garner Ave, between 290th St and 300th St. By small creek that runs up to Garner Ave on west side.
5	300th and Franklin - Owego	Woodbury	42.2720994	-96.1333467	West side of Franklin Ave. and 300th St. intersection
6	Brown's Lake	Woodbury	42.286491	-96.4043639	This site shows up in Nebraska. No TRS given so I am not exactly sure where the survey site is at Brown's Lake. 1/28/2015 EK.