

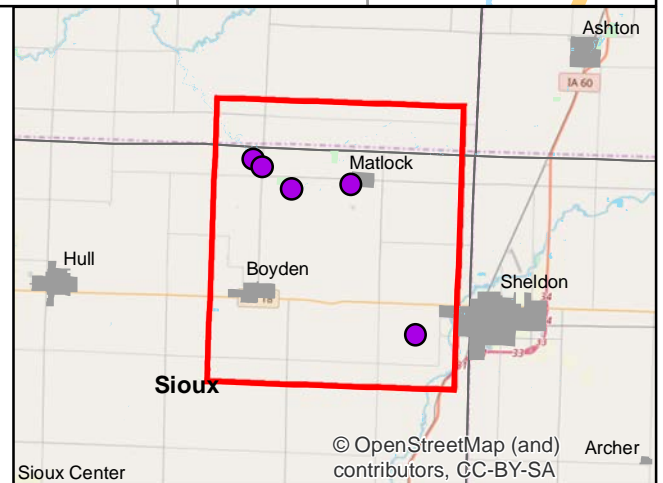

Volunteer Wildlife Monitoring Program (VWMP) Frog and Toad Survey

Route ID: 113 County: Sioux

Click for Google Maps to Site 1: <https://www.google.com/maps/dir/?api=1&destination=43.2518632138,-96.0064807846>

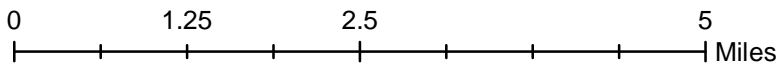
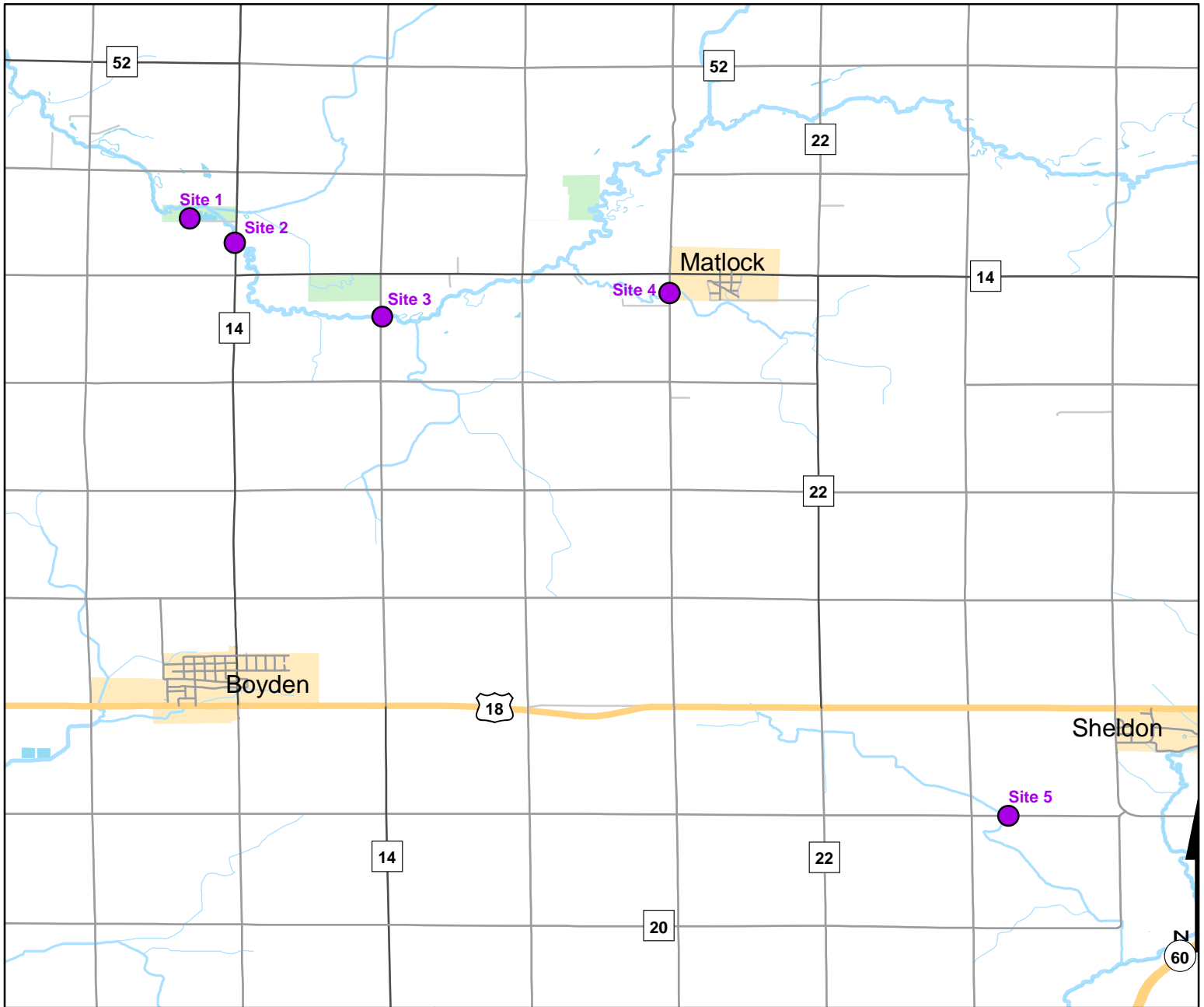

© OpenStreetMap (and) contributors, CC-BY-SA



Volunteer Wildlife Monitoring Program (VWMP) Frog

Route ID: 113 County: Sioux

Click for Google Maps to Site 1: <https://www.google.com/maps/dir/?api=1&destination=43.2518632138,-96.0064807846>

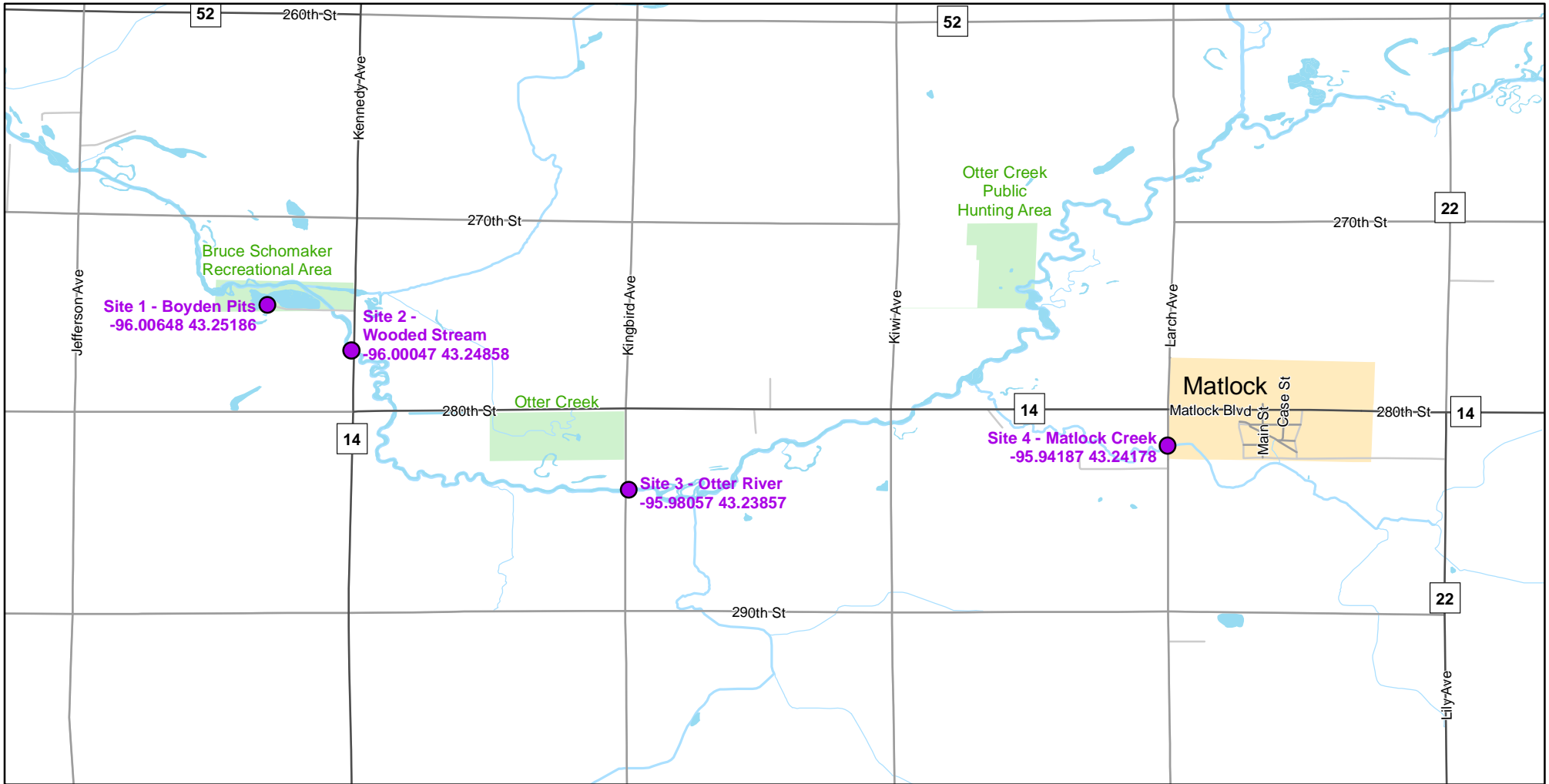

Enlarged View of Site 4

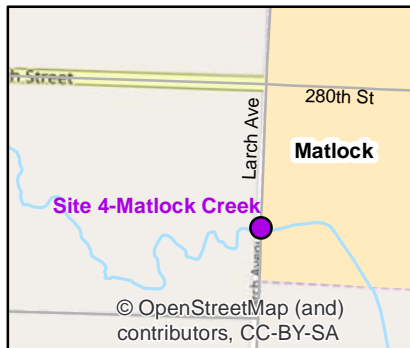

Legend

----- Trails

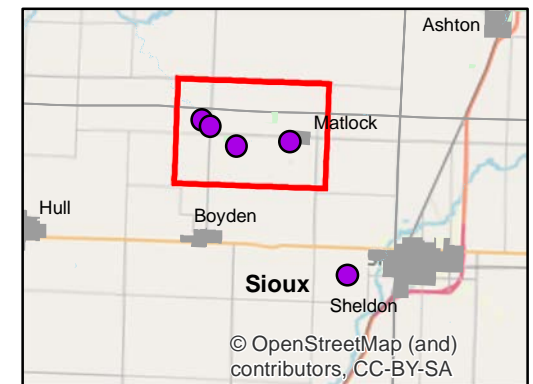
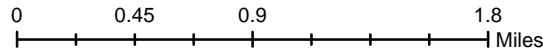



Volunteer Wildlife Monitoring Program (VWMP) Frog and Toad Survey

Route ID: 113 County: Sioux

Click for Google Maps to Site 1: <https://www.google.com/maps/dir/?api=1&destination=43.2518632138,-96.0064807846>

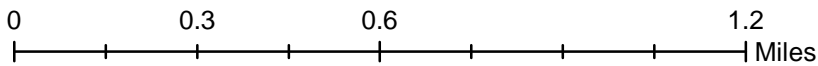
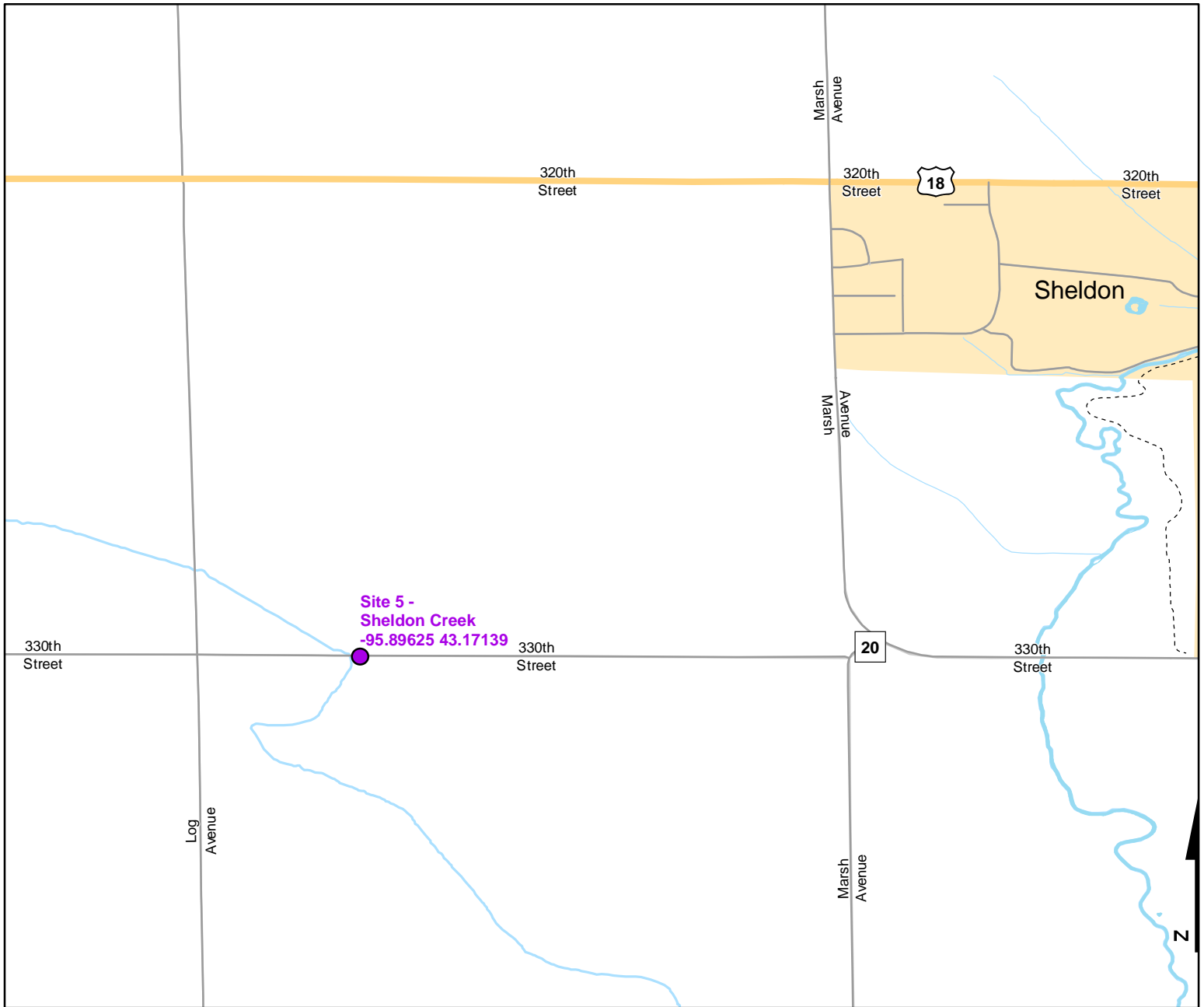

Legend

----- Trails

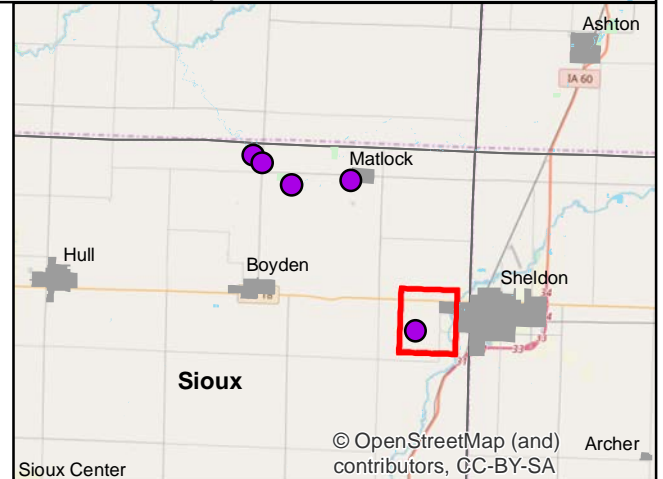



Frog and Toad Call Survey Route Description

Route ID **113**

Established: 1993

Site Number	Name	County	Latitude	Longitude	Directions
0	Boyden Creek	Sioux	43.1762447	-95.9394423	1/4 mile North of 3100 Larch Avenue, West side of road
1	Boyden Pits	Sioux	43.2518632	-96.0064808	1/2 mile North of 2800 Kennedy Avenue, then west to the West shore of Boyden Pit
2	Wooded Stream	Sioux	43.2485817	-96.0004685	1/4 mile North of 2800 Kennedy Avenue at bridge, west side of road
3	Otter River	Sioux	43.2385678	-95.9805676	1/3 mile south of 2800 Kingbird Avenue, west side of road
4	Matlock Creek	Sioux	43.2417764	-95.941867	1/4 mile South of 2800 Larch Avenue, West side of road
5	Sheldon Creek	Sioux	43.1713954	-95.8962513	1/4 mile East of 3100 Log Avenue, North side of road