

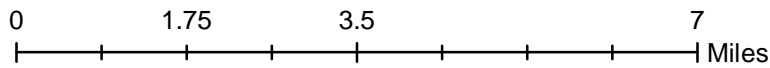

Volunteer Wildlife Monitoring Program (VWMP) Frog and Toad Survey

Route ID: 78 County: Bremer

Click for Google Maps to Site 1: <https://www.google.com/maps/dir/?api=1&destination=42.8464120902,-92.3193590824>

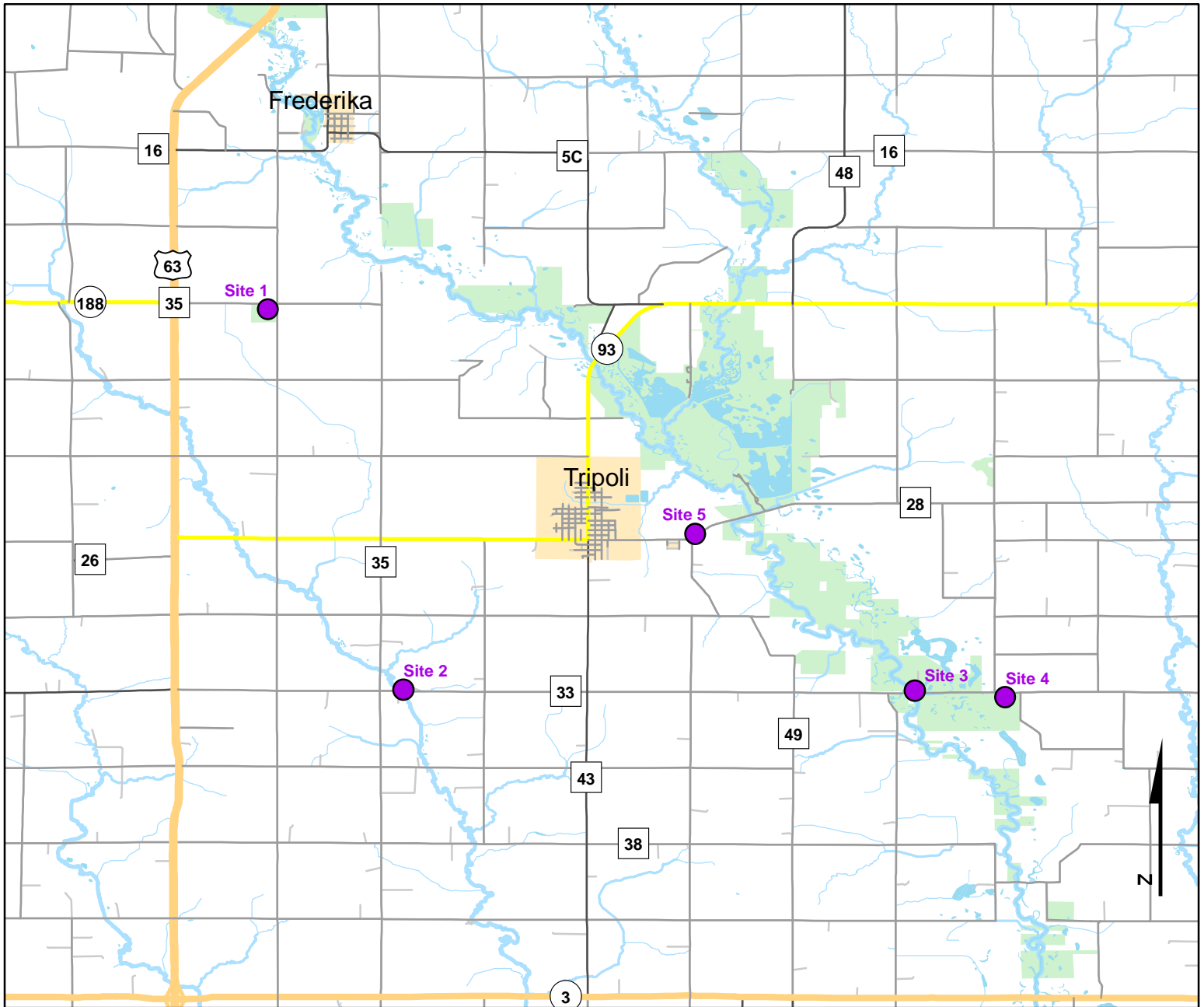

DNR
**Volunteer
 Wildlife
 Monitoring
 Program**

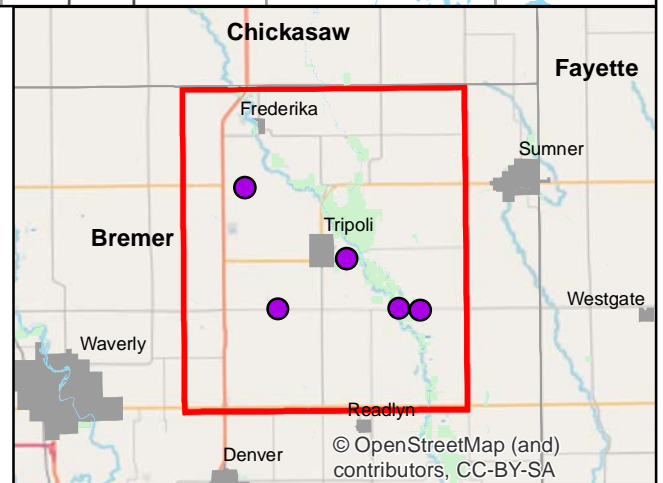



Volunteer Wildlife Monitoring Program (VWMP) Frog and Toad Survey

Route ID: 78 County: Bremer

Click for Google Maps to Site 1: <https://www.google.com/maps/dir/?api=1&destination=42.8464120902,-92.3193590824>

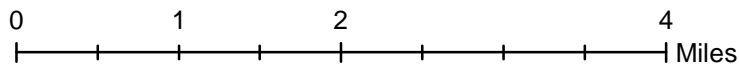
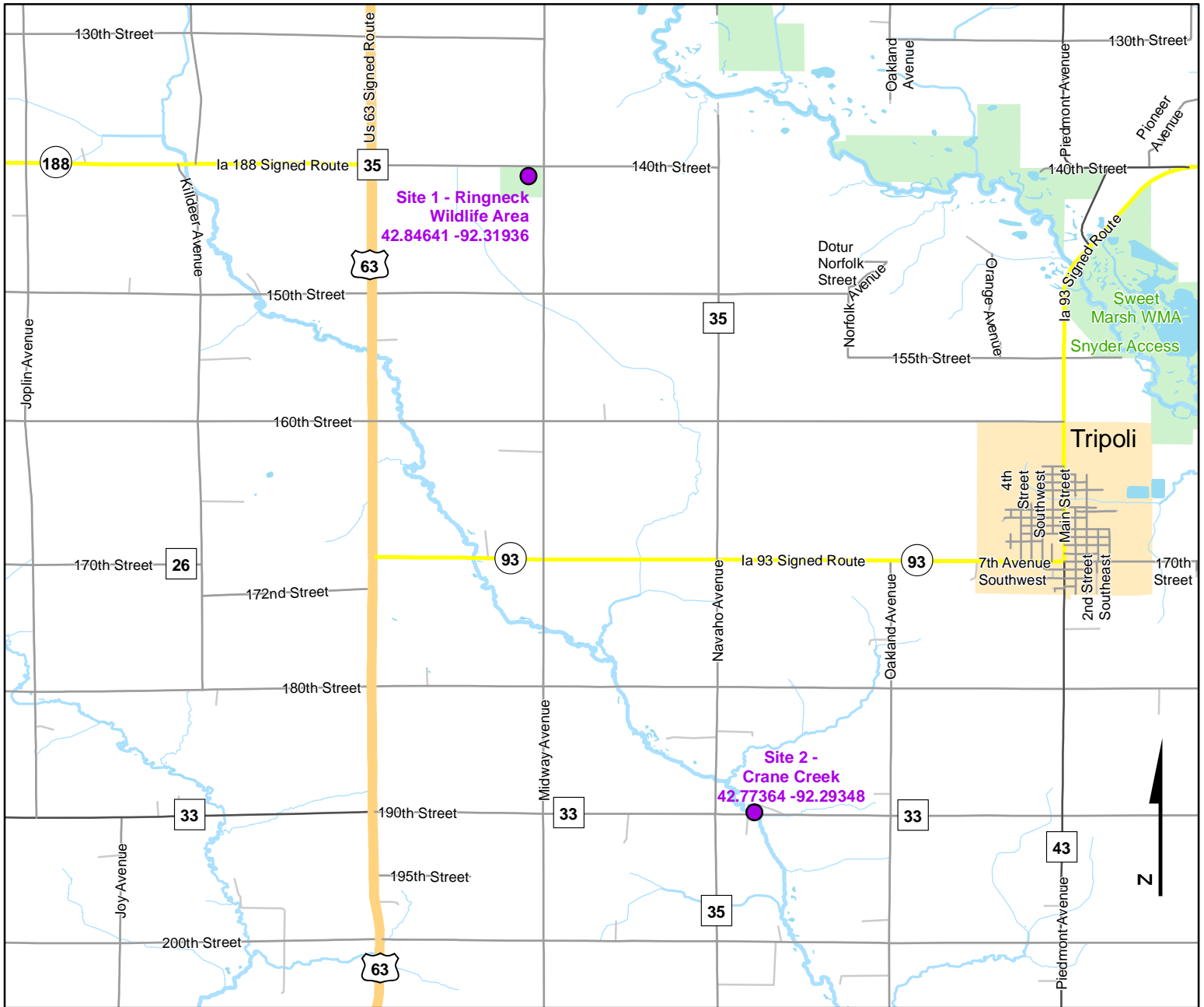

Legend

----- Trails

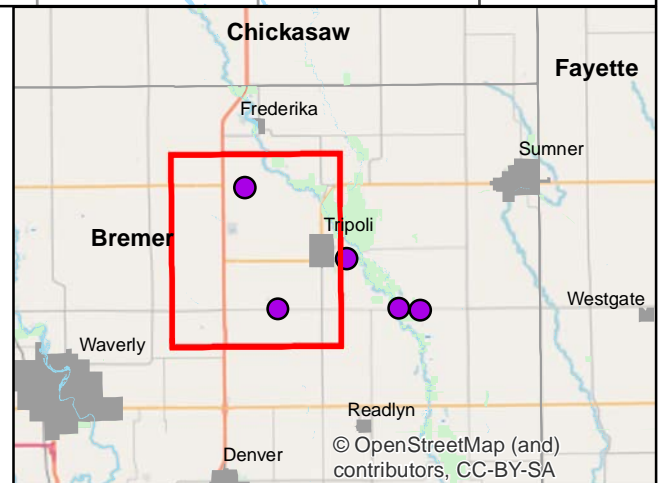



Volunteer Wildlife Monitoring Program (VWMP) Frog and Toad Survey

Route ID: 78 County: Bremer

Click for Google Maps to Site 1: <https://www.google.com/maps/dir/?api=1&destination=42.8464120902,-92.3193590824>

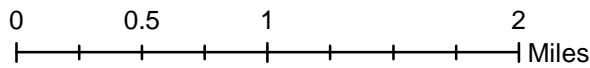
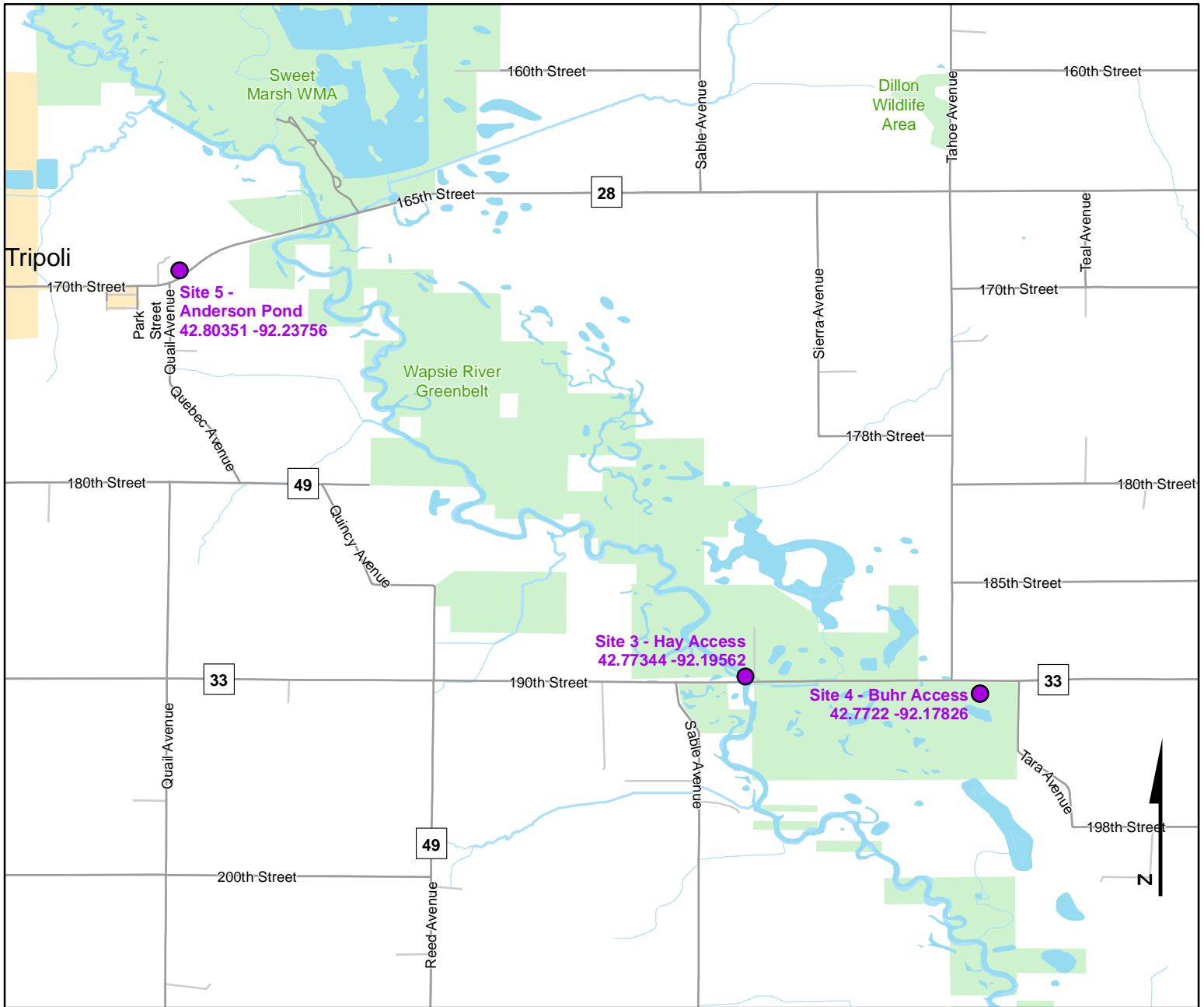

Legend

----- Trails

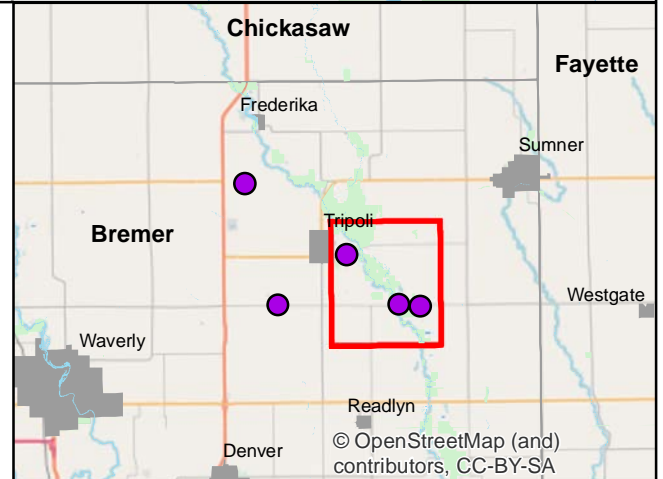



Frog and Toad Call Survey Route Description

Route ID **78**

Established: 1992

Site Number	Name	County	Latitude	Longitude	Directions
1	Ringneck Wildlife Area	Bremer	42.8464121	-92.3193591	From Tripoli: 3 mile west on 93, 3 mile north on Midway (gravel).
2	Crane Creek	Bremer	42.7736363	-92.2934842	2.5 mil east of Hwy 63 on C-33
3	Hay Access	Bremer	42.773441	-92.1956228	3.5 East of V43 on C-33 at county area below bridge.
4	Buhr Access	Bremer	42.772201	-92.178257	4 mile east of V-43 on C-33
5	Anderson Pond	Bremer	42.8035086	-92.2375604	1.5 mile east of Tripoli on road to marsh