

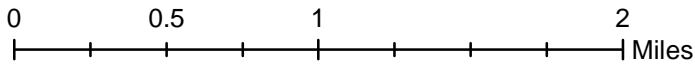

# Volunteer Wildlife Monitoring Program (VWMP) Frog and Toad Survey

Route ID: 47 County: Winneshiek

Click for Google Maps to Site 1: <https://www.google.com/maps/dir/?api=1&destination=43.3310973603,-91.6719340536>

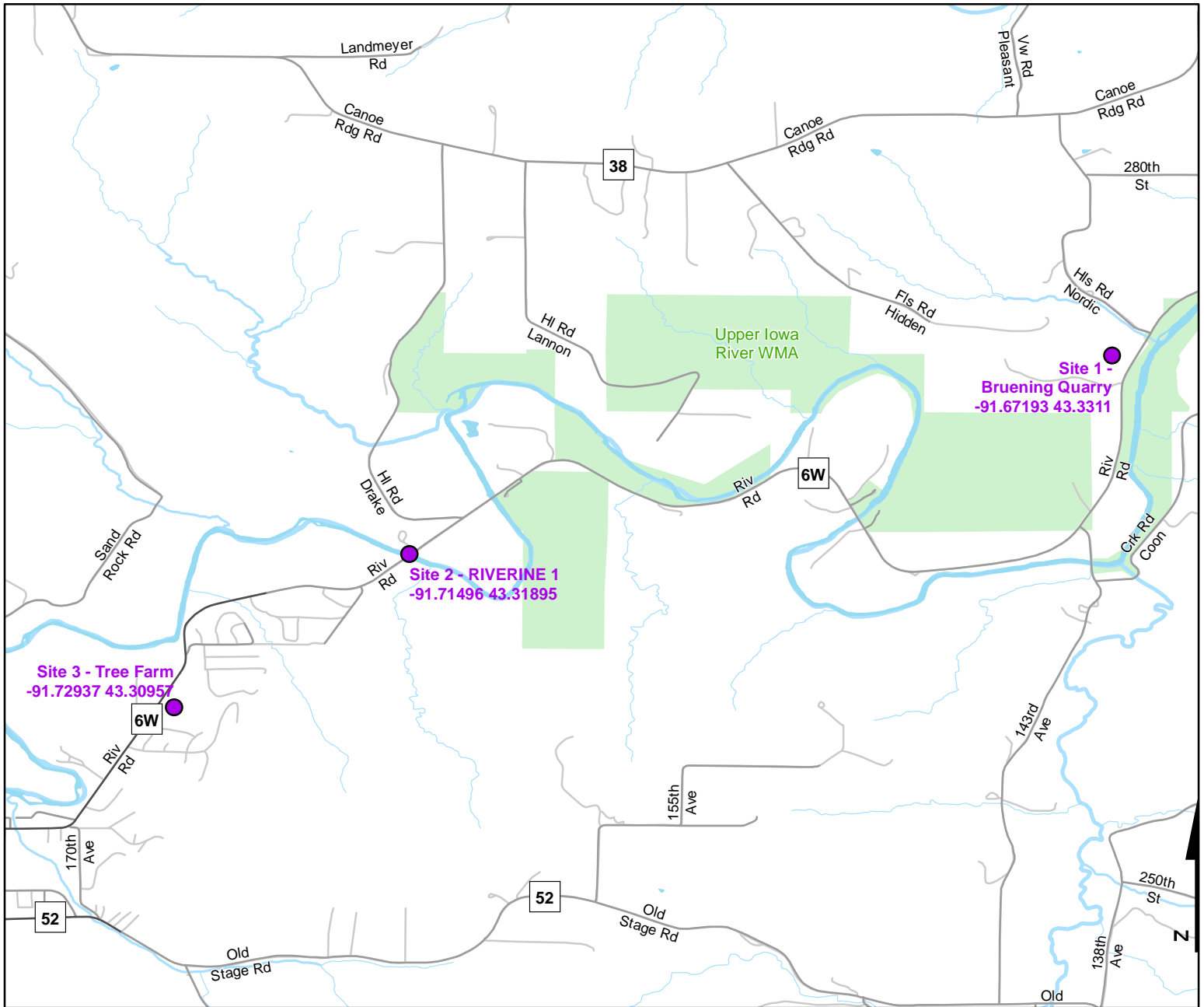

## Legend

----- Trails

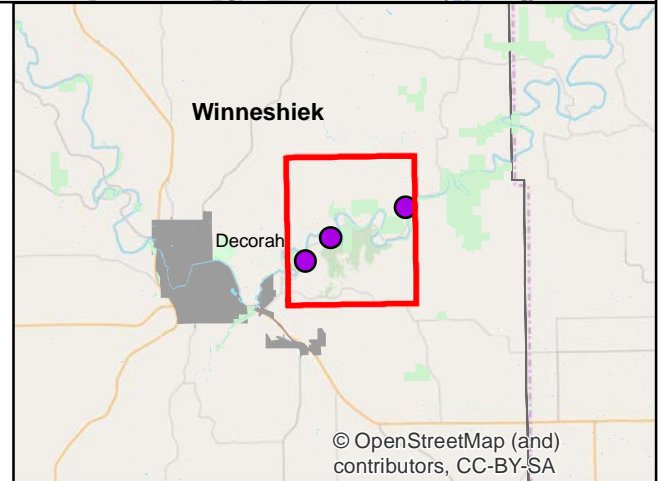



# Frog and Toad Call Survey Route Description

Route ID

Established:

Site Number	Name	County	Latitude	Longitude	Directions
<input type="text" value="1"/>	<input type="text" value="Bruening Quarry"/>	<input type="text" value="Winneshieck"/>	<input type="text" value="43.3310974"/>	<input type="text" value="-91.6719341"/>	<input type="text" value="Intersection of River Road and Nordic Hills. Flooded Quarry."/>
<input type="text" value="2"/>	<input type="text" value="RIVERINE 1"/>	<input type="text" value="Winneshieck"/>	<input type="text" value="43.3189466"/>	<input type="text" value="-91.7149554"/>	<input type="text" value="The description for this site is identical to another site on this route. 1/2 mile east of McMaster bridge over Upper Iowa River."/>
<input type="text" value="3"/>	<input type="text" value="Tree Farm"/>	<input type="text" value="Winneshieck"/>	<input type="text" value="43.309572"/>	<input type="text" value="-91.7293701"/>	<input type="text" value="Dredged area just east of Woodland Acres Tree Farm on south side of River road."/>