

Volunteer Wildlife Monitoring Program (VWMP) Frog and Toad Survey

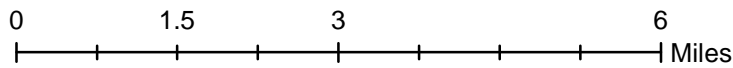

Route ID: 203 County: Cedar

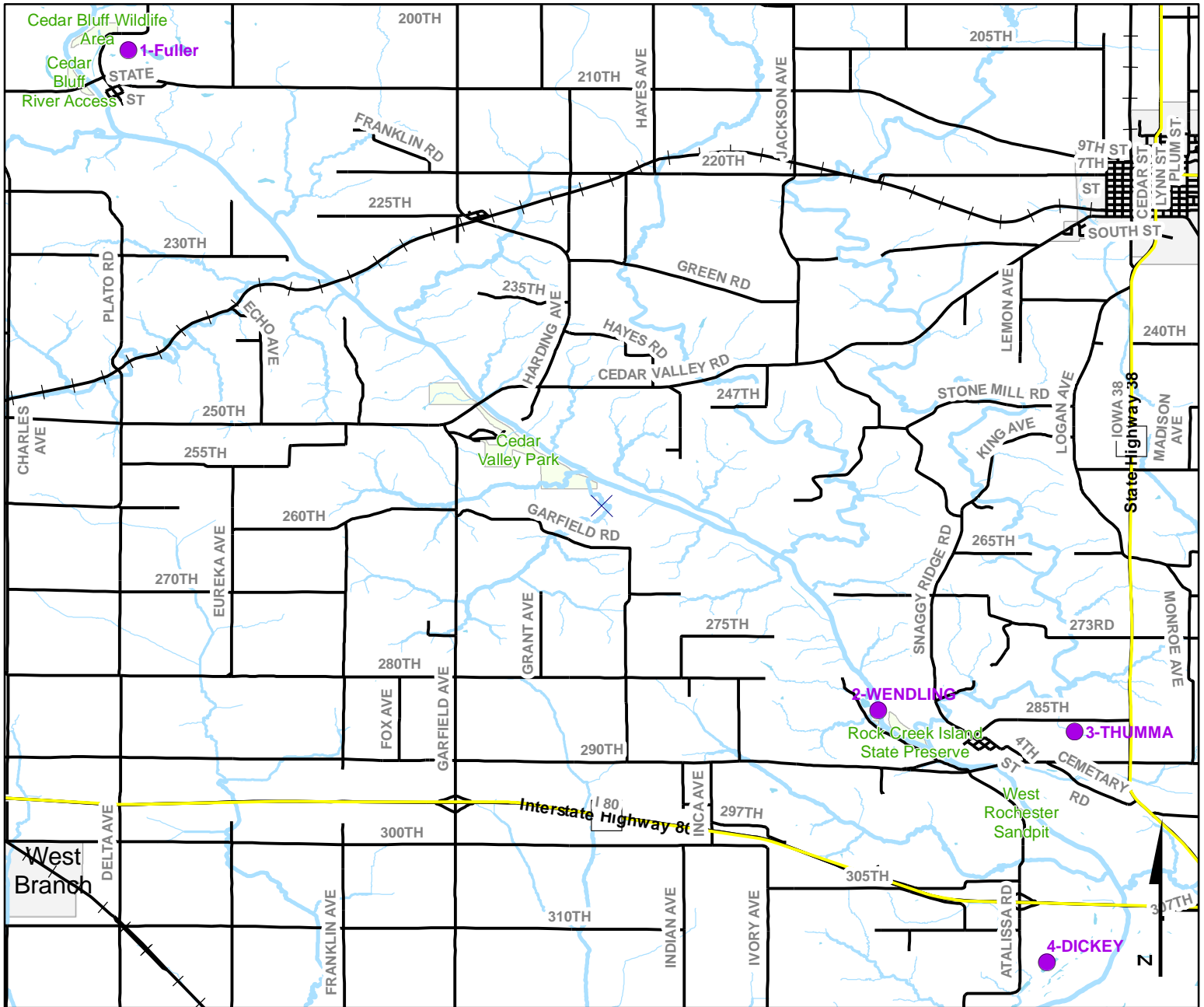

DNR
Volunteer Wildlife Monitoring Program

Legend

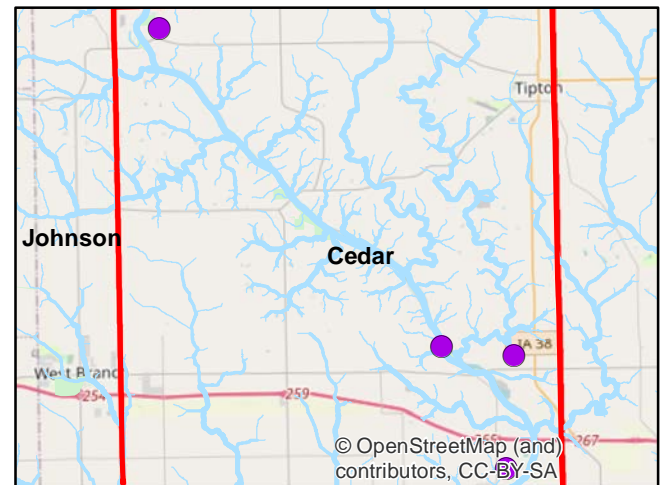

Volunteer Wildlife Monitoring Program (VWMP) Frog and Toad Survey



Route ID: 203 County: Cedar

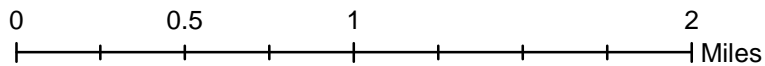
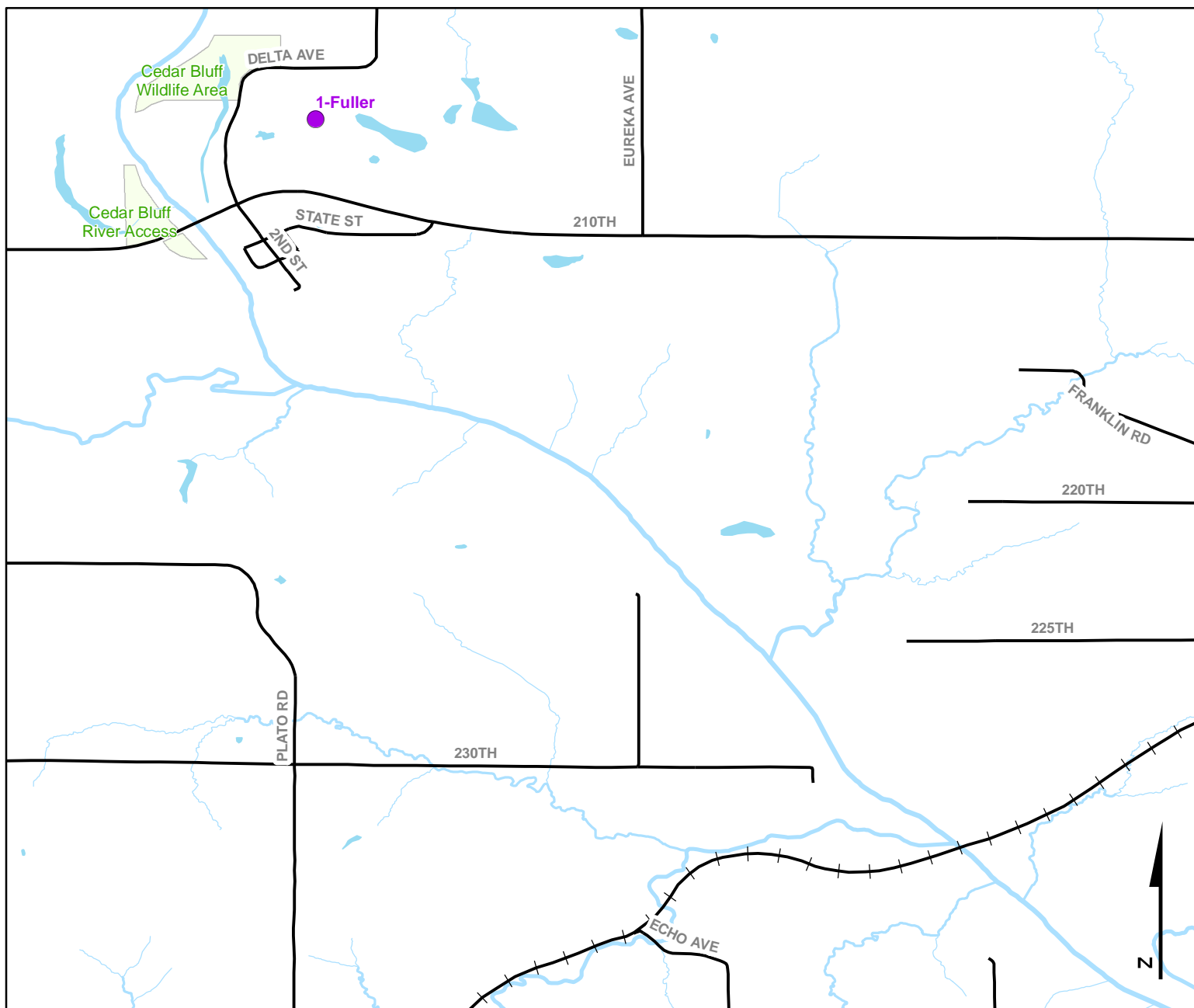

Legend

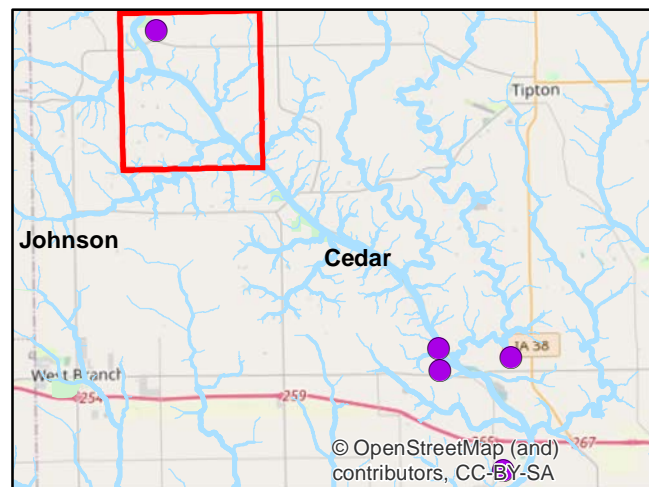

Volunteer Wildlife Monitoring Program (VWMP) Frog and Toad Survey



Route ID: 203 County: Cedar

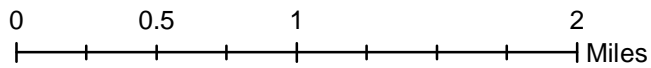
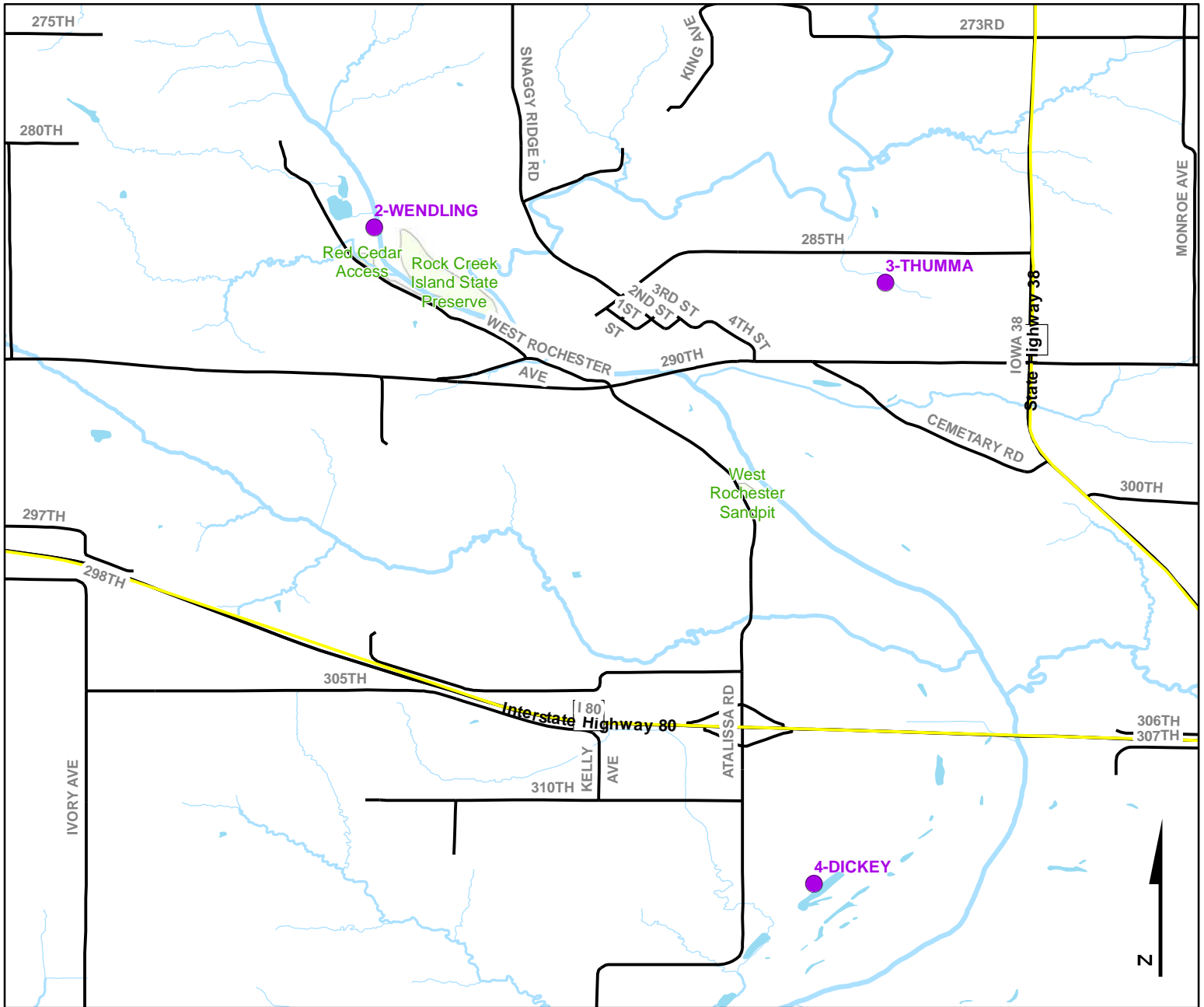

Legend

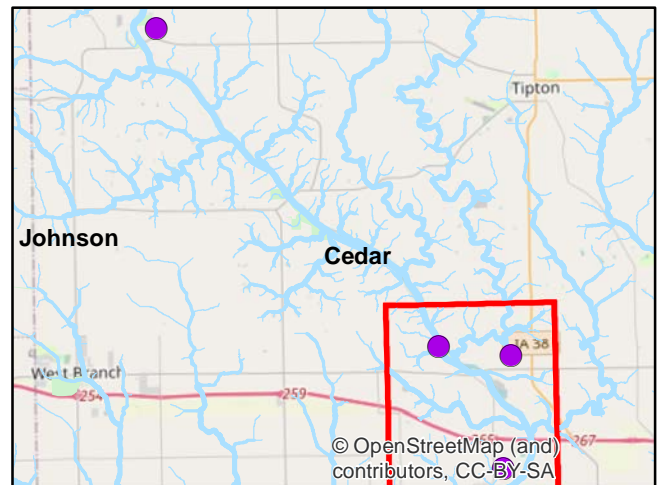

VOLUNTEER WILDLIFE MONITORING PROGRAM

Survey Route Description

Route 203

Name

Address

Phone

E-mail

Site No	Site Name	County	T	R	S	Q	Latitude	Longitude	Wetland Type
1	Fuller	Cedar	81N	4W	27	SW	41.7936461	-91.3061652	Open Marsh
Description: Large Dunal Pond surrounded by woods but dominated by marsh veg. NW Quarter of the SW Quarter. Back of Blow sand ridge near Cedar River. May dry up. 2-3 acres.									
2	WENDLING	Cedar	79N	3W	3	NE	41.6792714	-91.1763127	Timbered Riverine
3	THUMMA	Cedar	79N	3W	1	N	41.6755949	-91.1423292	Open Riverine
4	DICKEY	Cedar	79N	3W	24	NW	41.6356827	-91.1471138	Timbered Riverine