

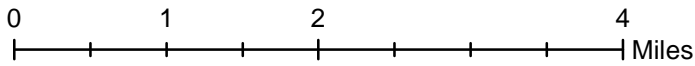

Volunteer Wildlife Monitoring Program (VWMP) Frog and Toad Survey

Route ID: 184 County: Guthrie

Click for Google Maps to Site 1: <https://www.google.com/maps/dir/?api=1&destination=41.6886289319,-94.3971937678>

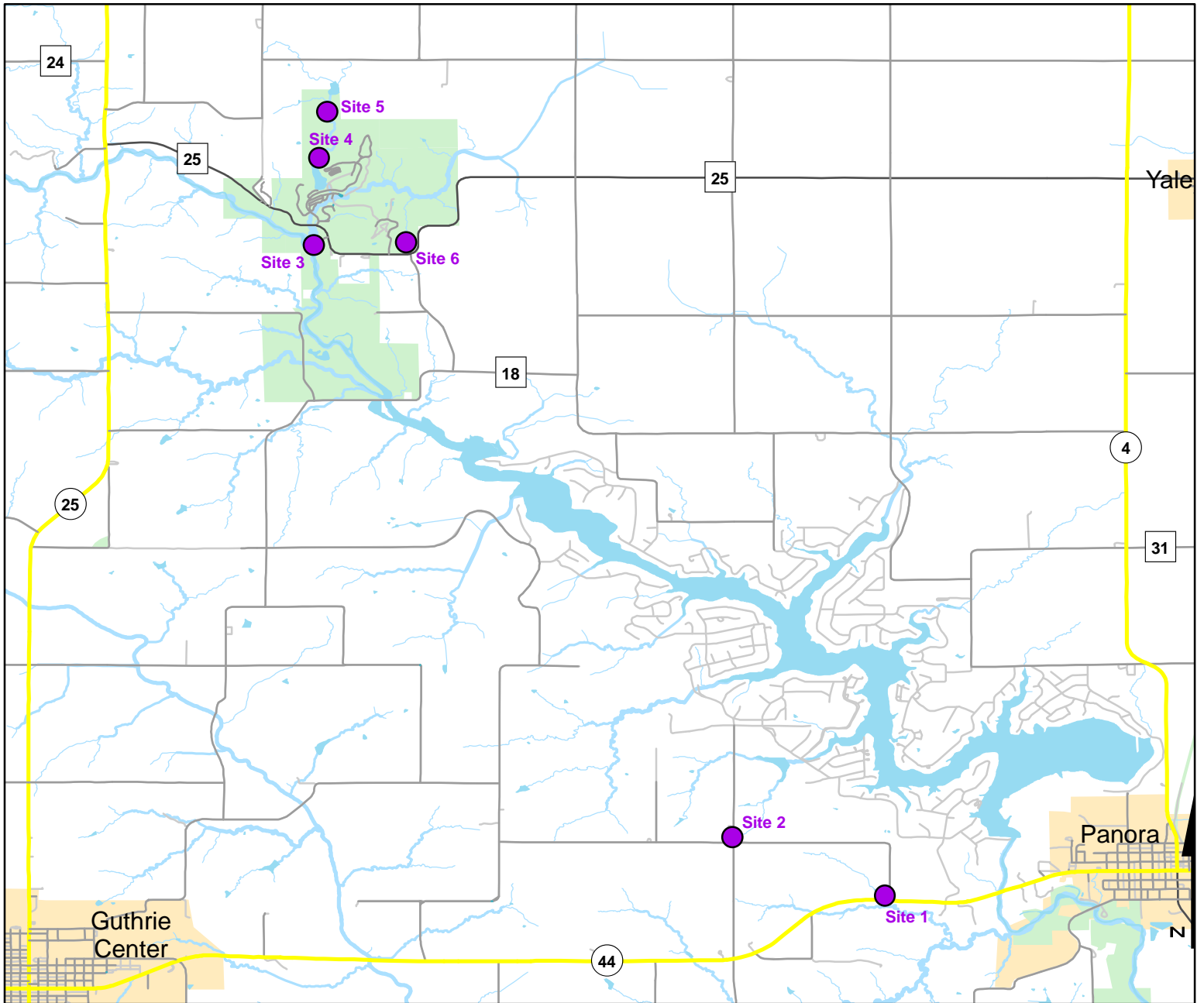

DNR
**Volunteer
 Wildlife
 Monitoring
 Program**

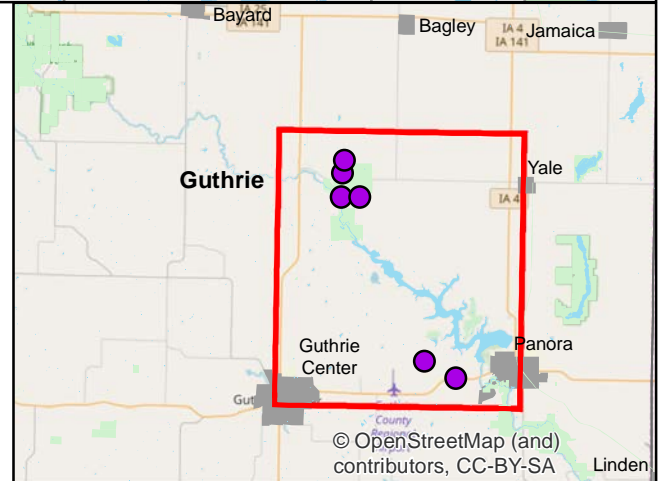



Volunteer Wildlife Monitoring Program (VWMP) Frog and Toad Survey

Route ID: 184 County: Guthrie

Click for Google Maps to Site 1: <https://www.google.com/maps/dir/?api=1&destination=41.6886289319,-94.3971937678>

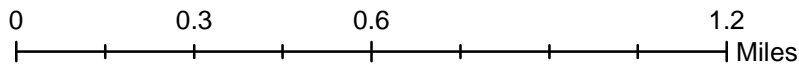
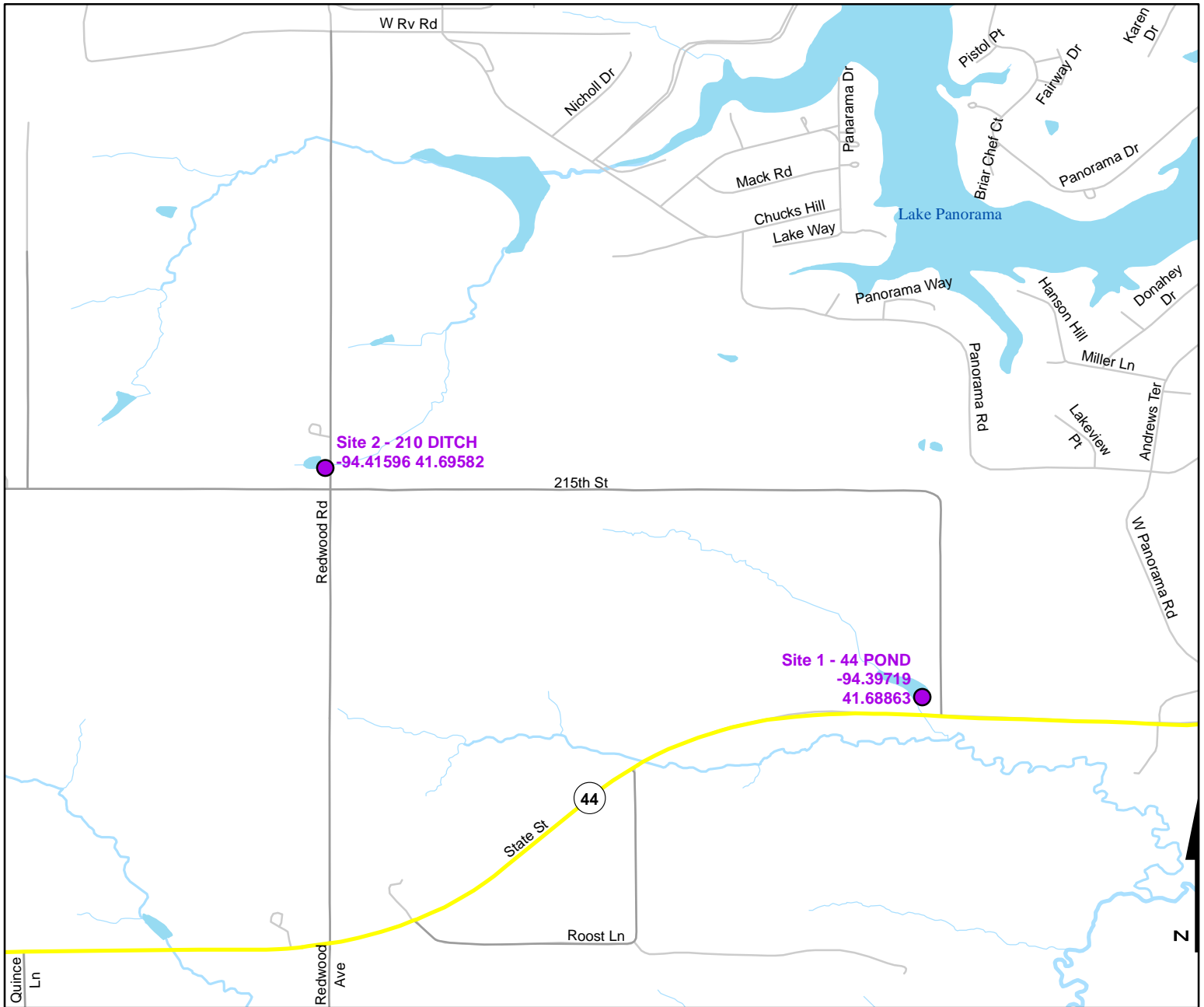

Legend

----- Trails

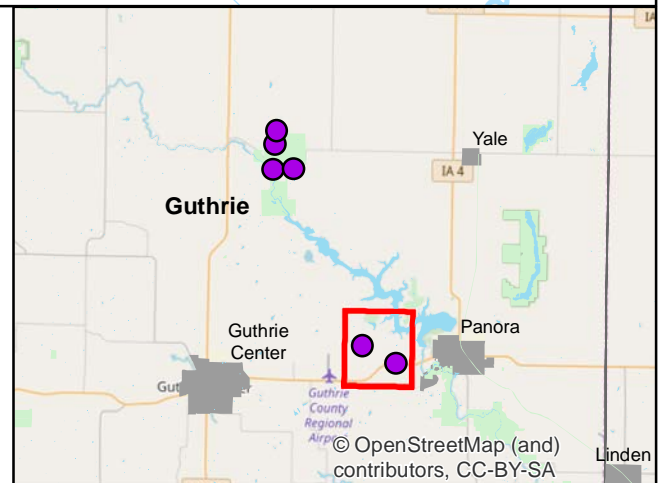



Volunteer Wildlife Monitoring Program (VWMP) Frog and Toad Survey

Route ID: 184 County: Guthrie

Click for Google Maps to Site 1: <https://www.google.com/maps/dir/?api=1&destination=41.6886289319,-94.3971937678>

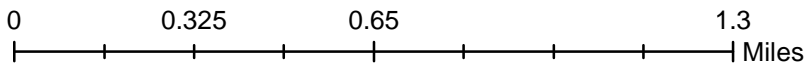
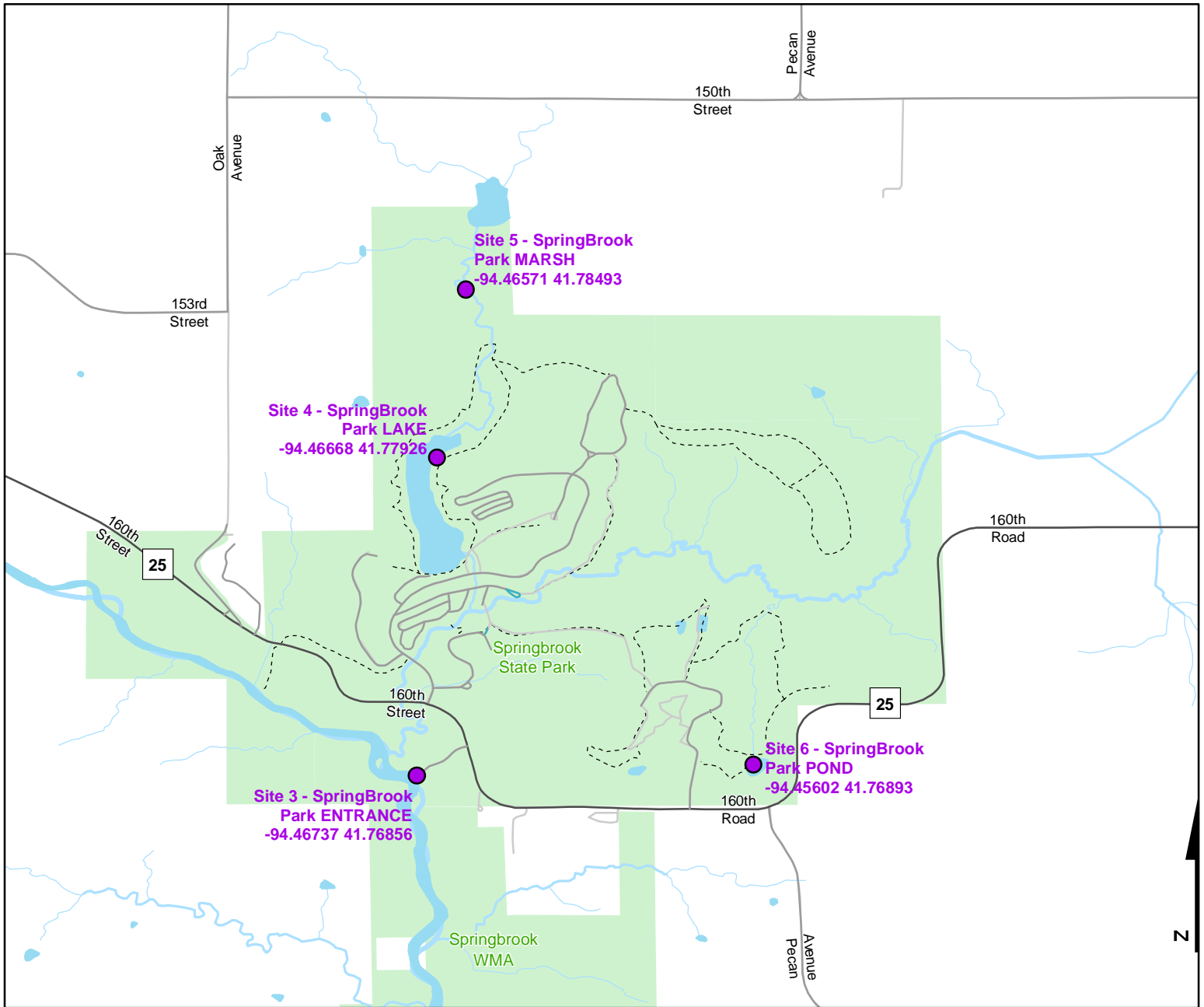

Legend

----- Trails

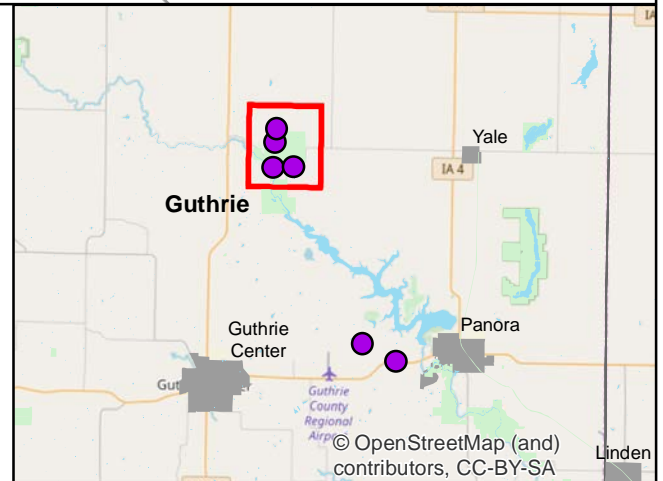



Frog and Toad Call Survey Route Description

Route ID **184**

Established: 1998

Site Number	Name	County	Latitude	Longitude	Directions
1	44 POND	Guthrie	41.6886289	-94.3971938	At the T-intersection of Hwy 44 and 215th St
2	210 DITCH	Guthrie	41.6958208	-94.4159641	Northwest of 215th St and Redwood Rd intersection (ditch and small pond)
3	SpringBrook Park ENTRANCE	Guthrie	41.7685628	-94.4673703	Public use parking, 1/2 mile west of Springbrook Park entrance
4	SpringBrook Park LAKE	Guthrie	41.7792626	-94.4666757	On springbrook trail from beach to seat (bench?) near upper-end of lake
5	SpringBrook Park MARSH	Guthrie	41.7849311	-94.4657099	Upper end cross over on Springbrook trail from beach
6	SpringBrook Park POND	Guthrie	41.7689324	-94.4560216	Conservation Education Center SE Pond, just northeast of education center