

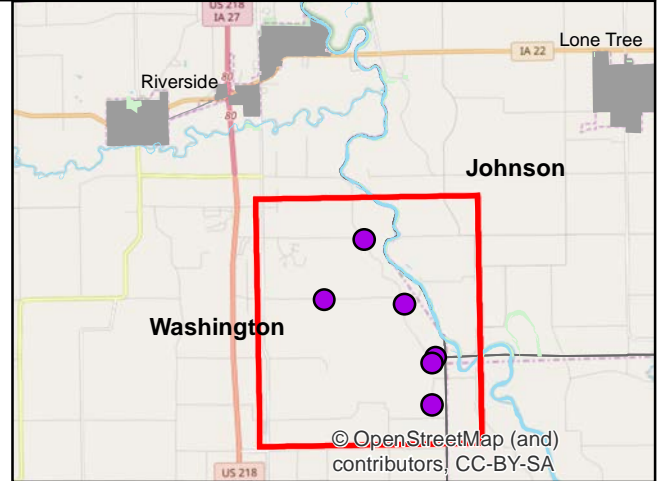

Volunteer Wildlife Monitoring Program (VWMP) Frog and Toad Survey

Route ID: 123 County: Washington

Click for Google Maps to Site 1: <https://www.google.com/maps/dir/?api=1&destination=41.4522347543,-91.5091454644>

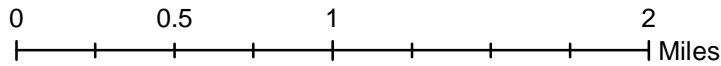
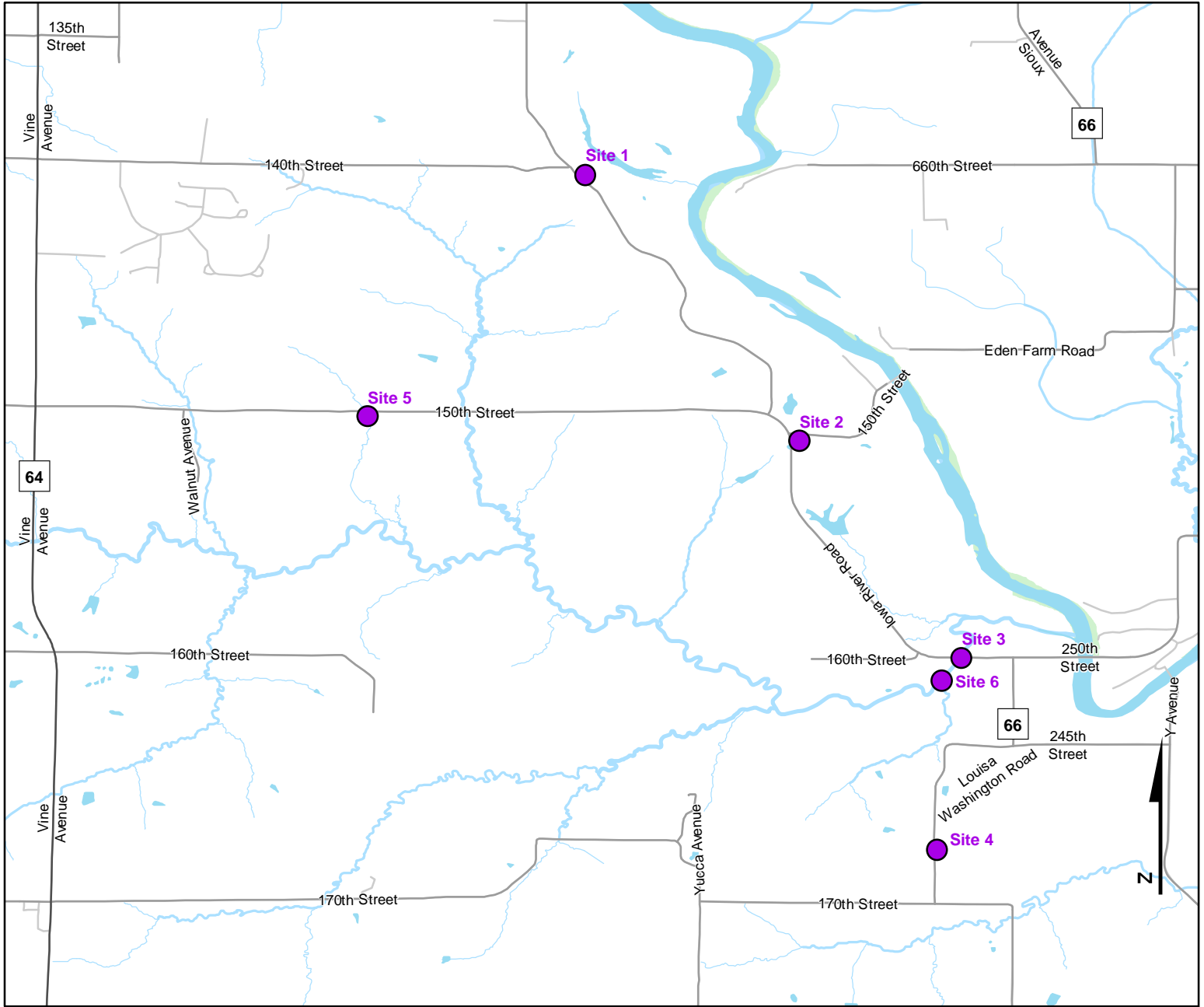



Volunteer Wildlife Monitoring Program (VWMP) Frog and Toad Survey

Route ID: 123 County: Washington

Click for Google Maps to Site 1: <https://www.google.com/maps/dir/?api=1&destination=41.4522347543,-91.5091454644>

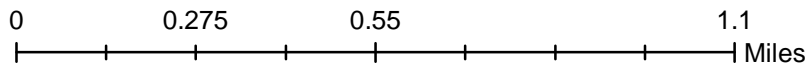
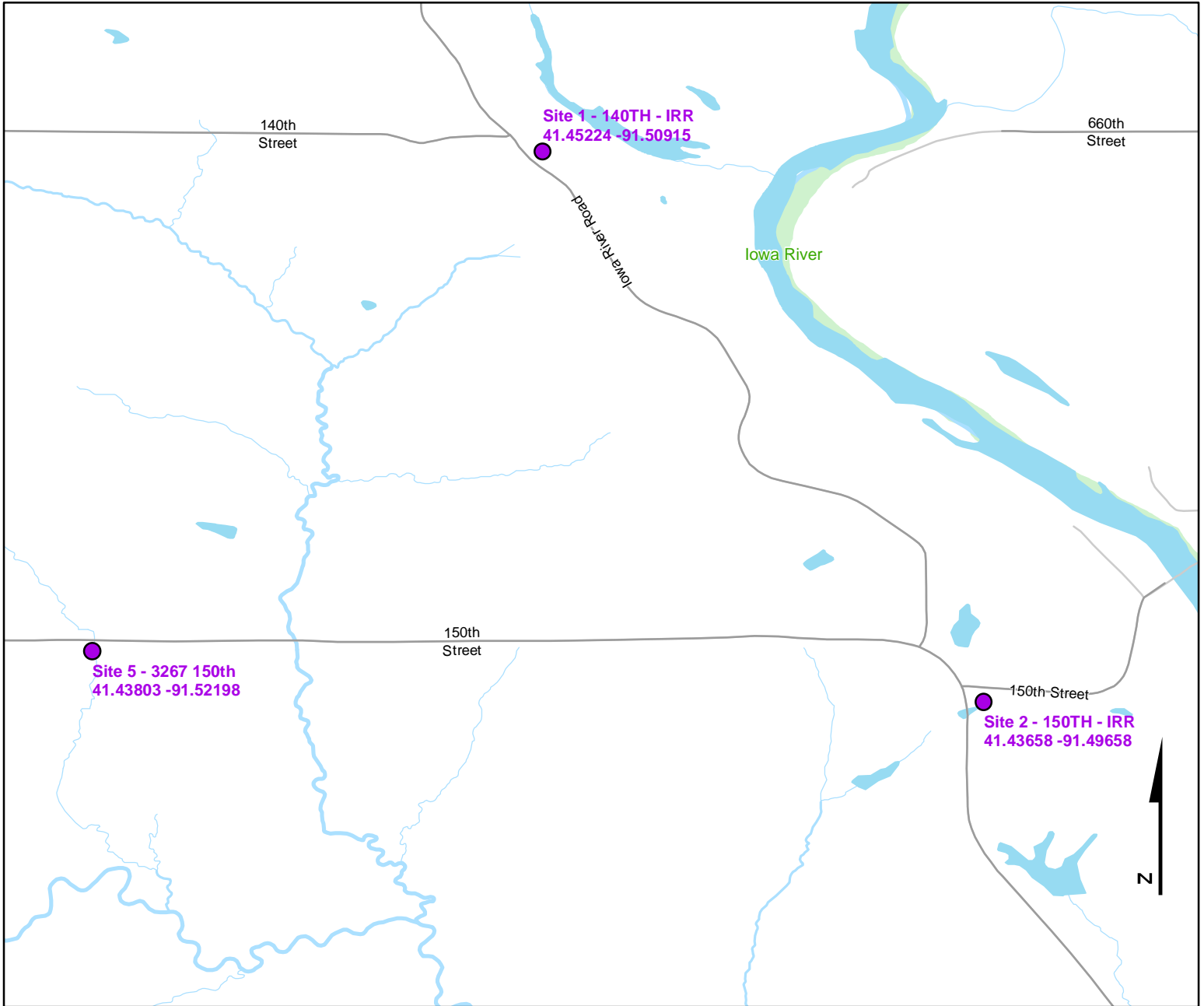

Legend

----- Trails

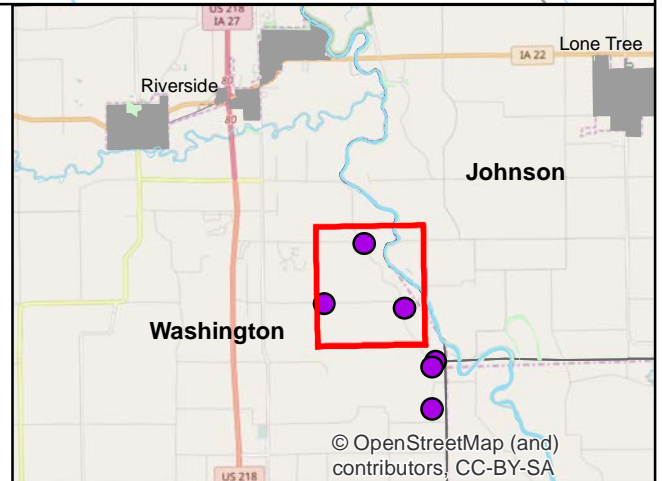



Volunteer Wildlife Monitoring Program (VWMP) Frog and Toad Survey

Route ID: 123 County: Washington

Click for Google Maps to Site 1: <https://www.google.com/maps/dir/?api=1&destination=41.4522347543,-91.5091454644>

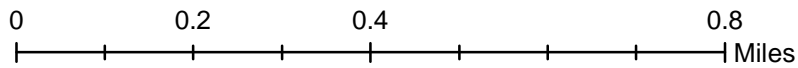
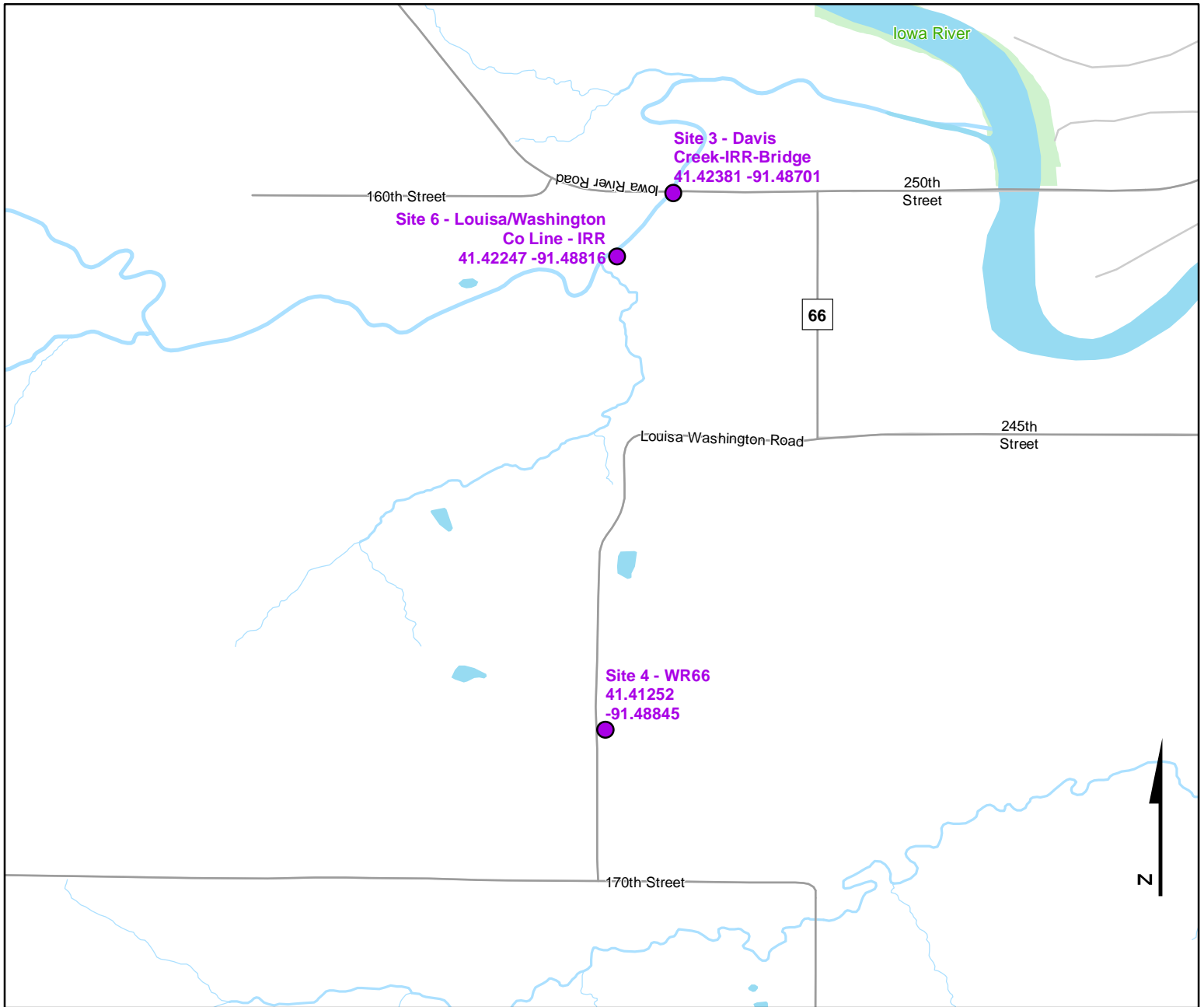

Legend

----- Trails

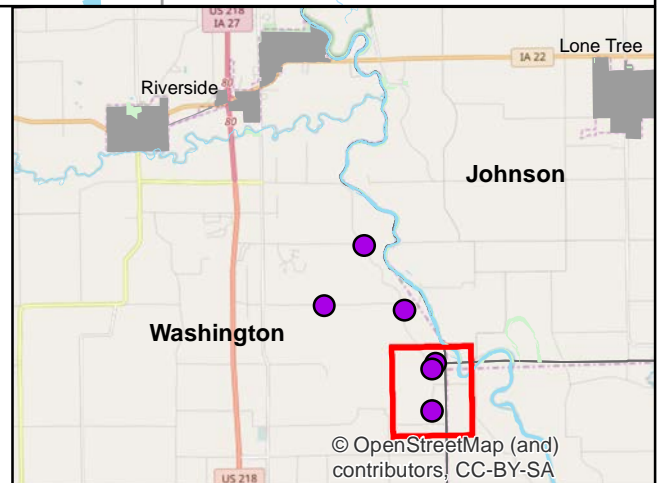

© OpenStreetMap (and contributors), CC-BY-SA



Frog and Toad Call Survey Route Description

Route ID **123**

Established: 1994

Site Number	Name	County	Latitude	Longitude	Directions
1	Davis Creek-IRR-Bridge	Washington	41.4238074	-91.4870111	At the first bridge West of the Yucca Ave. and Iowa River Rd. intersection
2	150TH - IRR	Washington	41.4365789	-91.4965771	Small pond on the corner of 150th St (part of 150th that goes East to the river) and Iowa River Rd,
3	140TH - IRR	Washington	41.4522348	-91.5091455	At the intersection of 140th St and Iowa River Rd, on the East side of the Iowa River Rd
4	3267 150th	Washington	41.438025	-91.5219789	1 mile East on 150th St. from the Vine Ave. and 150th St. intersection. On South side of road.
5	WR66	Washington	41.4125222	-91.4884456	1/10 mile North of 170th St. and Yucca Ave. intersection. Listen from side of the road.
6	Louisa/Washington Co Line - IRR	Washington	41.4224713	-91.488155	